



EBARA

TECHNICAL DATA BOOK

50Hz

EBARA SLURRY PUMP MODEL SAL



SECTION	DESCRIPTION
1	FEATURES
2	APPLICATIONS
3	PERFORMANCE CHART
4	SPECIFICATION
5	DATA SHEET
6	RECOMMENDED SPARE PARTS
7	INSPECTION AND TESTS
	SECTIONAL VIEW
	DIMENSIONS (BARE SHAFT PUMP)
	DIMENSIONS (WITH MOTOR)
	PERFORMANCE CURVE

Features

■Features

1. The limit load characteristics of the specially-designed pumps control horsepower regardless of the pump flow.
2. The direct coupled type pumps that ensure stable operation are available as standard specifications.
3. Special cast iron is used for the casing and impeller to offer high wear resistance.
4. The effect of the rear impeller vanes reduces leakage from the gland packing.

Applications

■ Applications

1. For recycling of cutting fluids, grinding fluids, and cleaning solutions
2. For various types of wastewater treatment and pumping effluent wastewater
3. For fishery (e.g. pumping of seawater for aquaculture and processing of fish and shellfish)
4. For paper industry (e.g. transfer of pulp, white water, and clay)

Performance Chart 50Hz

Synchronous speed: 1500min⁻¹

Shaded portion Synchronous speed: 1000min⁻¹

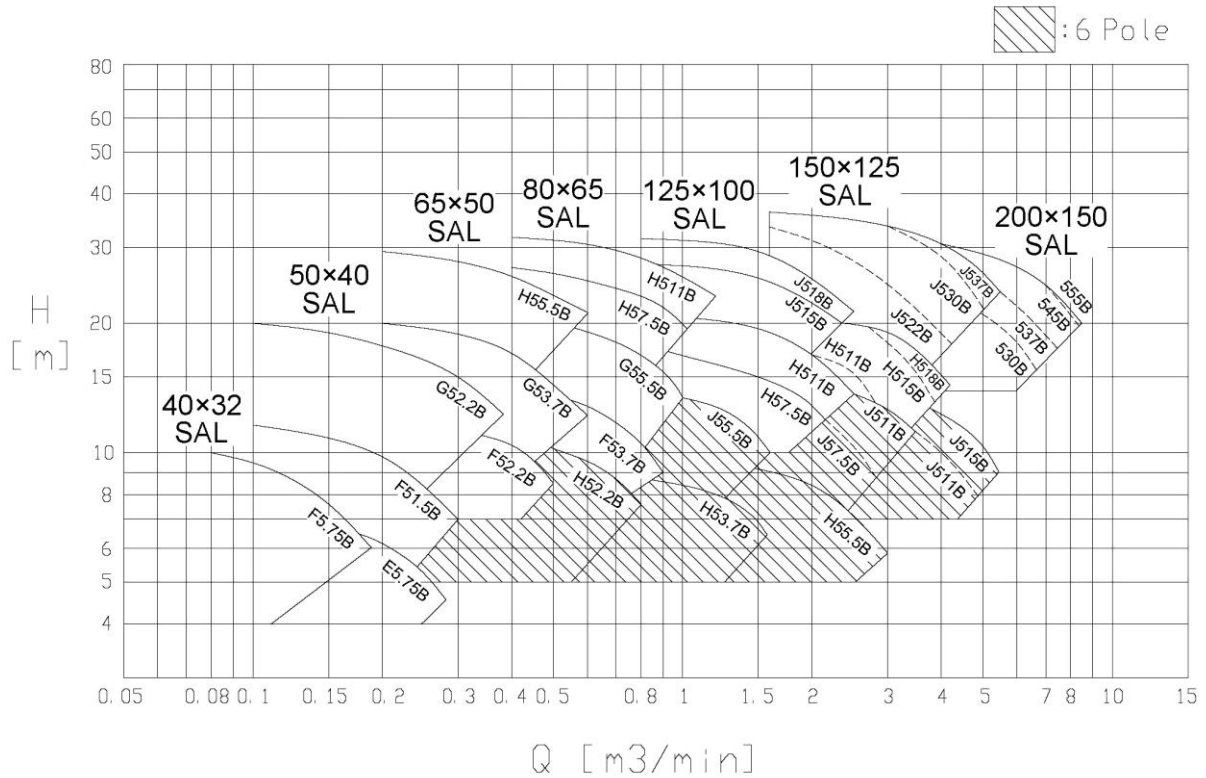

■ Model Code

65 X 50	SALG	5	3.7	BL	
①	②	③	④	⑤	⑥
① Suction Size (mm)		② Discharge Size (mm)			
③ Model		④ Frequency (5 : 50Hz, 6 : 60Hz)			
⑤ Motor Output (kW)		⑥ Identification Code			

■ Performance Table 50Hz

Size mm	Model	Motor Output kW	Pole	Capacity m ³ /min	Total Head m	Capacity m ³ /min	Total Head m	Capacity m ³ /min	Total Head m
40X32	40X32SALF5.75BL	0.75	4	0.08	10.2	0.14	8.2	0.18	6.1
50X40	50X40SALE5.75BL	0.75	4	0.18	6.6	-	-	0.28	4.6
	50X40SALF5.5BL	1.5		0.10	11.9	0.2	10	0.30	7.0
	50X40SALG52.2BL	2.2		0.10	19.9	0.24	16.7	0.38	12.5
65X50	65X50SALF52.2BL	2.2	4	0.36	11.0	-	-	0.50	8.6
	65X50SALG53.7BL	3.7		0.20	20.0	0.4	17	0.60	12.5
	65X50SALH55.5BL	5.5		0.20	29.0	0.4	25.5	0.60	21.0
80X65	80X65SALF53.7BL	3.7	4	0.58	13.0	-	-	0.90	9.0
	80X65SALG55.5BL	5.5		0.58	19.3	0.8	16.5	1.05	13.0
	80X65SALH57.5BL	7.5		0.40	27.0	0.7	24	1.05	19.5
	80X65SALH51.1BL	11		0.40	32.0	0.8	29	1.25	23.0
	80X65SALH52.2BL	2.2	6	0.52	10.0	-	-	0.80	7.5
125X100	125X100SALH57.5BL	7.5	4	0.86	17.2	1.5	15	2.10	12.0
	125X100SALH51.1BL	11		1.06	20.5	1.8	18	2.50	14.0
	125X100SALH53.7BL	3.7	6	0.85	8.8	-	-	1.60	6.5
	125X100SALJ515BL	15	4	0.90	28.0	1.7	24.5	2.30	20.0
	125X100SALJ518BL	18.5		0.90	33.0	1.6	29.5	2.55	22.0
	125X100SALJ55.5BL	5.5		6	1.00	13.0	-	-	1.65

Specification

■ STANDARD SPECIFICATIONS

LIQUID	Slurry liquid including particle 0~80°C
TOTAL SUCTION HEAD	-5m : 125X100SAL and below -3m : 150X125SAL and above
ALLOWABLE POSITIVE SUCTION PRESSURE	0.1MPa (1kgf/cm ²)
CONSTRUCTION	
IMPELLER	Semi open with rear vane
SHAFT SEAL	Gland packing
FLUSHING ※1	External flushing SALE,F,G: 2~3L/minX0.1MPa{1kgf/cm ² } SAL,H,J: 3~5L/minX0.2MPa{2kgf/cm ² }
BEARING	Sealed ball bearing : SALE, F, G Oil bath ball bearing : SALH,J
FLANGE	Equivalent to JIS 10K normal type (notch bolt hole type)
MATERIALS	
CASING	Chromium cast iron
IMPELLER	High-chromium cast iron
SHAFT	SUS403 : SALE,F,G S35C : SALH,J
SHAFT SLEEVE	SUS403
MOTOR	Three phase, 4 pole or 6 pole 50Hz:3phase/380-415V, 60Hz:3phase/380-415V Total enclosed
Drive method	Motor direct drive flexible coupling

※1) External flushing is necessary to protect gland packing and shaft sleeve.
Please provide Fresh water.

This model cannot be used for food-related liquid transport.

In the case of facilities for living creatures (such as fish farms, cages or aquariums), a spare machine must be prepared since there is a risk of lack of oxygen due to pump failure.

In the case of important equipment (such as computer cooling equipment or freezer cooling equipment), a spare machine must be prepared in case of pump failure.

Depending on the equipment used, flush out the pump sufficiently and check it before use since cutting fluid, rubber mold material or foreign material etc. from pump manufacturing may be mixed in with the liquid used.

CENTRIFUGAL PUMP DATA SHEET

1 CUSTOMER _____ 2 USER _____ 3 SERVICE _____ 4 JOB NO. _____ 5 ITEM NO. _____ 6 DOC. NO. _____	NO. PUMPS REQ' D. _____ NO. DRIVERS _____ MOTOR _____ TURBINE _____ ENGINE _____ EBARA SER. NO. _____ PUMP SIZE AND TYPE _____
OPERATING CONDITIONS	PERFORMANCE
8 LIQUID _____	NPSH Req. (Aq.) _____
9 PUMPING TEMP. _____	EFFICIENCY _____
10 DENSITY at P. T. _____ kg/ℓ	SHAFT POWER _____
11 VISCOSITY _____	DRIVER OUTPUT _____
12 VAPOR PRESS. _____	PUMP SPEED _____
13 CAPACITY _____	ROTATION VIEWED FROM COUPLING END _____
14 TOTAL HEAD _____	MIN. FLOW _____
15 SUCT. PRESS. _____	AUXILIARY PIPING
16 DISCH. PRESS. _____	FLUSHING <input type="checkbox"/> SELF <input type="checkbox"/> EX. <input type="checkbox"/> PLUG <input type="checkbox"/> SELF+EX. _____
17 DIFF. PRESS. _____	LIQUID _____
18 NPSH Av. (Aq.) _____	CONNECT. _____
19 CORR. /EROS. _____	PRESS. _____
20 SOLID _____	TEMP. _____
21 CONCENTRATION _____	CAP. _____
CONSTRUCTION	COOLING : BRG. ST. BOX PED. COOLER _____
23 NOZZLES SIZE RATING FACING POSITION	CAP. _____
24 SUCTION _____	TOTAL _____
25 DISCHARGE _____	CONNECT. _____
26 _____	PRESS. _____
27 PUMP TYPE <input type="checkbox"/> HORIZONTAL <input type="checkbox"/> VERTICAL	TEMP. _____
28 CASE - MOUNT. <input type="checkbox"/> FOOT <input type="checkbox"/> CENTERLINE <input type="checkbox"/> BRACKET <input type="checkbox"/> IN-LINE	JACKET HYD. TEST PRESS. _____
29 - SPLIT <input type="checkbox"/> RADIAL <input type="checkbox"/> AXIAL	QUENCH NONE _____
30 - VOLUTE <input type="checkbox"/> SINGLE <input type="checkbox"/> DOUBLE <input type="checkbox"/> DIFFUSER	MATERIALS
31 - PRESS. MAX. ALLOW. _____	CASING _____ C. W' RING _____
32 HYDRO. TEST _____	IMPELLER _____ I. W' RING _____
33 - CONNECT <input type="checkbox"/> VENT <input type="checkbox"/> DRAIN <input type="checkbox"/> GAGE	SHAFT _____
34 IMPELLER DIA. : () RATED _____	SLEEVE _____
35 MAX. _____	_____
36 TYPE : <input type="checkbox"/> CLOSED <input type="checkbox"/> SEMI-OPEN <input type="checkbox"/> OPEN	_____
37 MOUNT : <input type="checkbox"/> BETWEENBRGS. <input type="checkbox"/> OVERHUNG	_____
38 NO. OF STAGE _____	_____
39 BEARING TYPE : RADIAL _____	BASE PLATE _____
40 THRUST _____	SHOP TEST
41 LUBE : <input type="checkbox"/> RING OIL <input type="checkbox"/> FLOOD <input type="checkbox"/> GREASE	PERFORMANCE <input type="checkbox"/> NON-WIT <input type="checkbox"/> WIT.
42 <input type="checkbox"/> FLINGER	NPSH Req. <input type="checkbox"/> NON-WIT <input type="checkbox"/> WIT.
43 COUPLING TYPE <input type="checkbox"/> FLEXIBLE <input type="checkbox"/> GEAR <input type="checkbox"/> V-PULLEY	HYDROSTATIC <input type="checkbox"/> NON-WIT <input type="checkbox"/> WIT.
44 <input type="checkbox"/> RUBFLEX	DISMANTLE <input type="checkbox"/> NON-WIT <input type="checkbox"/> WIT.
45 SPACER : <input type="checkbox"/> YES <input type="checkbox"/> NO	VERTICAL PUMPS
46 GUARD : <input type="checkbox"/> YES <input type="checkbox"/> NO	PIT DEPTH _____
47 SHAFT SEAL _____	PUMP LENGTH _____
48 _____	MIN. SUBMERGENCE _____
49 _____	SUCT. CLEARANCE _____
MOTOR DRIVER	MASS : PUMP _____ BASE _____
51 MOTOR POWER _____ POLE _____ PHASE _____	DRIVER _____ TOTAL _____
52 _____ min ⁻¹ _____ V _____ Hz	_____
53 TYPE _____	_____
ACCESSORIES	_____
55 <input type="checkbox"/> BASE <input type="checkbox"/> FLANGE	_____
56 <input type="checkbox"/> FOUND. BOLT <input type="checkbox"/> TOOL	_____
57 <input type="checkbox"/> COUPLING	_____
58 <input type="checkbox"/> COUPLING GUARD	_____
59 <input type="checkbox"/> GAGE	_____
60 REMARKS _____	DATE _____ REV. : _____
61 _____	APPROVED BY _____
62 _____	CHECKED BY _____
63 _____	MADE BY _____

Recommended spare parts

■ SAL-E,F,G (50Hz)

MODEL	POLE	PART NAME								
		Shaft sleeve	Ball Bearing	Deflector	Oring	Gasket (Between casing and suction cover)	Gasket (Between casing and stuffing box)	Gasket (Between bearing housing and cover)	Gland Packing	V ring
No.		41	56	93	115	117-1	117-2	117-3	119	277
Qty		1	2	1	1	1	1	1	4	1
40X32SALF5.75BL	4	30	6306ZZ	30	1.5X24	200-30	30-0.5t	SBG-30	35X51X8	V-28A
50X40SALE5.75BL	4									
50X40SALF51.5BL	4									
50X40SALG52.2BL	4	35	6307ZZ	35	1.5X36	250-45	45-0.5t	SBG-35	45X65X9.5	V-32A
65X50SALF52.2BL	4									
65X50SALG53.7BL	4									
80X65SALF53.7BL	4	45	6309ZZ	45	1.5X36	250-45	45-0.5t	SBG-45	45X65X9.5	V-40A
80X65SALG55.5BL	4									

■ SAL-H,J (50Hz)

MODEL	POLE	PART NAME								
		Shaft sleeve	Ball Bearing	Ball Bearing	Oil Seal	Gasket (Between casing and suction cover)	Gasket (Between sleeve and impeller)	Gasket (Between casing and stuffing box)	Gasket (Between bearing housing and cover)	Gland Packing
No.		41	56-1	56-2	114	117-1	117-2	117-3	117-4	119
Qty		1	1	1	2	1	1	1	1/1	4
65X50SALH55.5BL	4	145	6309	7310BDB	SB45X68X12	320	145	145	130X100 /136X110	55X75X10
80X65SALH57.5BL	4									
80X65SALH511BL	4									
80X65SALH52.2BL	6									
125X100SALH57.5BL	4									
125X100SALH511BL	4									
125X100SALH53.7BL	6									
125X100SALJ515BL	4	160	6312	7313ADB	SB60X82X12	320	160	160	160X130 /172X140	70X95X12.5
125X100SALJ518BL	4									
125X100SALJ55.5BL	6									

To Be Determined

Sectional view

Model SAL-E,F,G

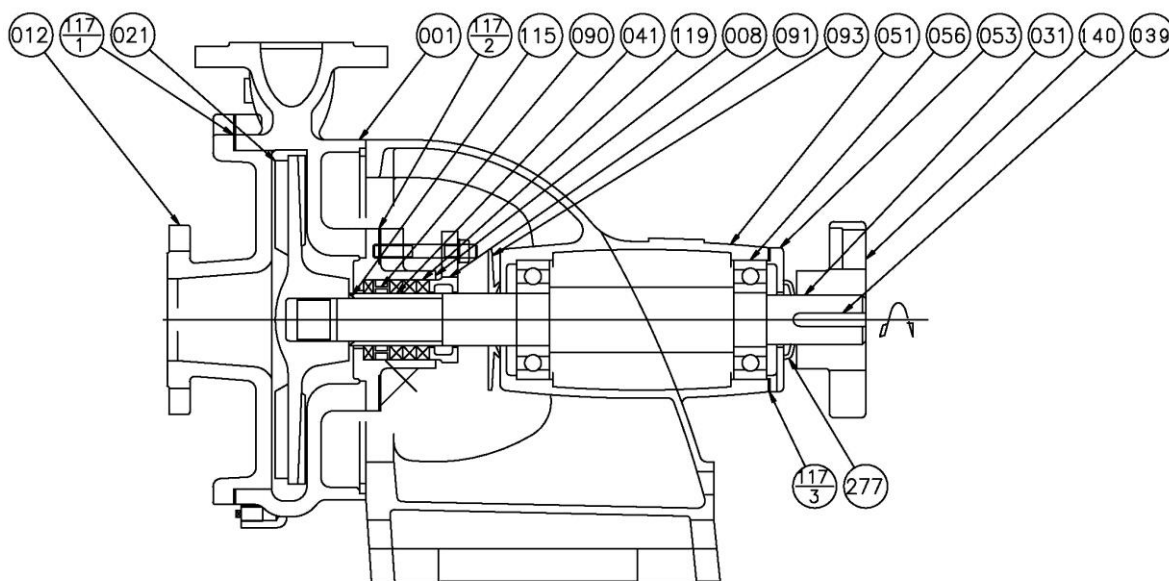

80X65 SALF,G	6309ZZ	36Xφ 1.5
65X50 SALF,G	6309ZZ	36Xφ 1.5
50X40 SALG	6307ZZ	24Xφ 1.5
50X40 SALE,F	6306ZZ	24Xφ 1.5
40X32 SALE,F	6306ZZ	24Xφ 1.5
MODEL	056	115
	BALL BEARING	O RING

No.	Part name	Material		Qty
277	V RING	RUBBER/NBR	RUBBER/NBR	1
140	COUPLING	FC200	CAST IRON	1
119	GLAND PACKING	CARBONIZED FIBER	CARBONIZED FIBER	4
117-3	GASKET	PRESS BOARD	PRESS BOARD	1
117-2	GASKET	NON ASBESTOS SHEET	NON ASBESTOS SHEET	1
117-1	GASKET	NON ASBESTOS SHEET	NON ASBESTOS SHEET	1
115	O RING	RUBBER/CR	RUBBER/CR	1
093	DEFLECTOR	RUBBER/NBR	RUBBER/NBR	1
091	GLAND	FC150	CAST IRON	1
090	LANTERN RING	SUS304	304 STAINLESS STEEL	1
056	SEALED BALL BEARING	-	-	2
053	BEARING COVER	FC150	CAST IRON	1
051	BEARING COVER	FC150	CAST IRON	1
041	SHAFT SLEEVE	SUS403	403 STAINLESS STEEL	1
039	KEY	S50C-N	CARBON STEEL	1
031	SHAFT	SUS403	403 STAINLESS STEEL	1
021	IMPELLER	HCrFC	HIGH CHROMIUM CAST IRON	1
012	SUCTION COVER	CrFC	CHROMIUM CAST IRON	1
008	STUFFING BOX	FC200	CAST IRON	1
001	CASING	CrFC	CHROMIUM CAST IRON	1

Sectional view

Model SAL-H,J

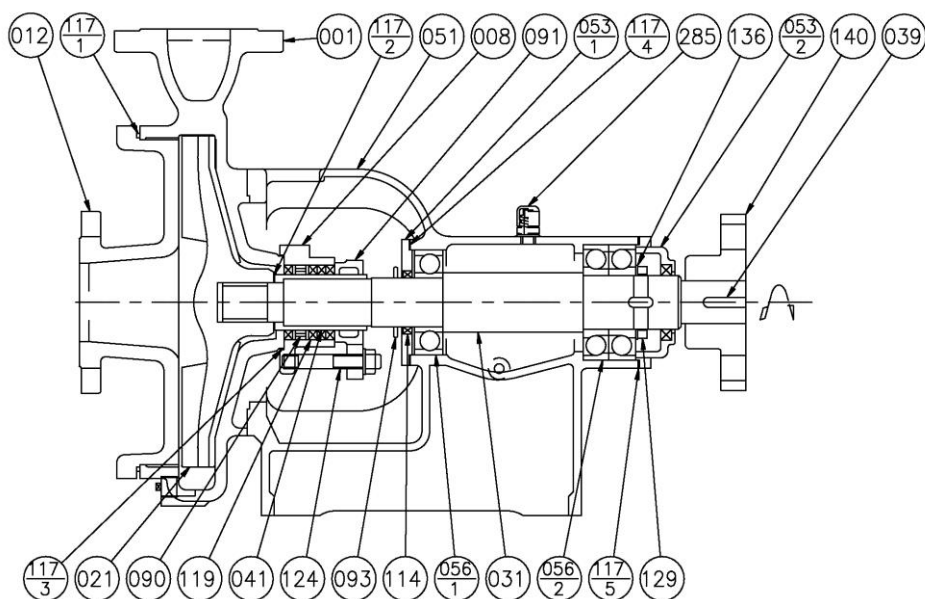

200X150 SALJ	6316	7318BDB	SB8010513	ISO VG-46 JIS K2213 #140	3.0	
150X125 SALJ	6312	7313ADB	SB608212		1.4	
150X125 SALH					0.8	
125X100 SALJ						
125X100 SALH	6309	7310BDB	SB456812	(L)		
80X65 SALH						
65X50 SALH						
50X40 SALH	MODEL	056-1 BALL BEARING	056-2 BALL BEARING	114 OIL SEAL	LUBRICANT OIL	CAPACITY

NO.	Part name	Material		Qty
285	AIR BREATHER	POLY CARBONATE	POLY CARBONATE	1
140	COUPLING	FC200	CAST IRON	1
136	WASHER	SS400	CARBON STEEL	1
129	NUT	SS400	CARBON STEEL	1
124	GLAND BOLTS	SUS403	403 STAINLESS STEEL	2
119	GLAND PACKING	CARBONIZED FIBER	CARBONIZED FIBER	4
117-5	GASKET	OIL SHEET	OIL SHEET	1
117-4	GASKET	OIL SHEET	OIL SHEET	1
117-3	GASKET	NON ASBESTOS SHEET	NON ASBESTOS SHEET	1
117-2	GASKET	PTFE	PTFE	1
117-1	GASKET	PTFE	NON ASBESTOS SHEET	1
114	OIL SEAL	RUBBER	RUBBER/NBR	2
093	DEFLECTOR	SUS316	31 6 STAINLESS STEEL	1
091	GLAND	FC150	CAST IRON	1
090	LANTERN RING	FC150	CAST IRON	1
056-2	BALL BEARING	-	-	1
056-1	BALL BEARING	-	-	1
053-2	BEARING COVER	FC200	CAST IRON	1
053-1	BEARING COVER	FC200	CAST IRON	1
051	BEARING HOUSING	FC200	CAST IRON	1
041	SHAFT SLEEVE	SUS420J1	420 STAINLESS STEEL	1
039	KEY	S50C-N	CARBON STEEL	1
031	SHAFT	S35C	CARBON STEEL	1
021	IMPELLER	HCrFC	HIGH CHROMIUM CAST IRON	1
012	SUCTION COVER	CrFC	CHROMIUM CAST IRON	1
008	STUFFING BOX	FC200	CAST IRON	1
001	CASING	CrFC	CHROMIUM CAST IRON	1

Dimensions (Bare shaft pump)

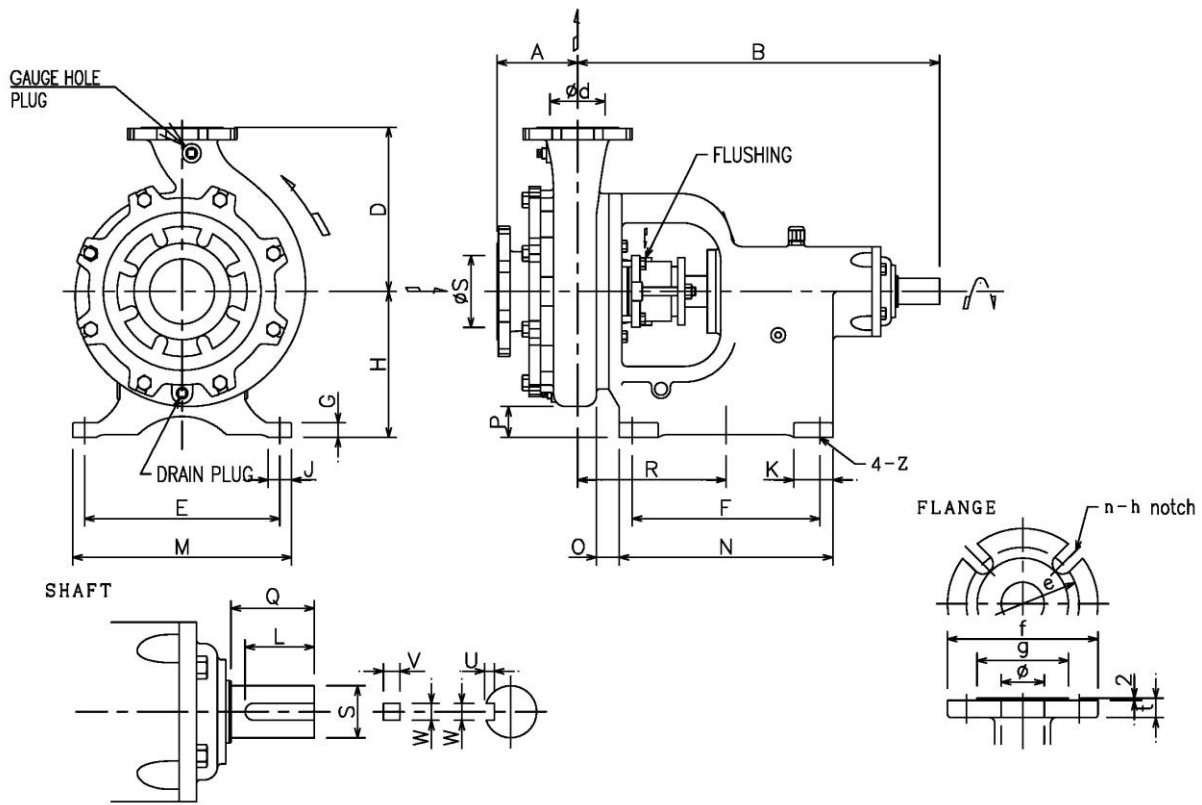

Unit : mm

MODEL	SUCTION FLANGE							DISCHARGE FLANGE						
	øS	g	e	f	t	n	h	ød	g	e	f	t	n	h
40X32SAL	40	85	105	140	18	4	19	32	80	100	135	18	4	19
50X40SAL	50	100	120	155	20	4	19	40	85	105	140	18	4	19
65X50SAL	65	120	140	175	22	4	19	50	100	120	155	20	4	19
80X65SAL	80	130	150	185	22	8	19	65	120	140	175	22	4	19
125X100SAL	125	185	210	250	24	8	24	100	155	175	210	24	8	19
150X125SAL	150	215	240	280	26	8	24	125	185	210	250	24	8	24
200X150SAL	200	265	290	330	26	12	24	150	215	240	280	26	8	24

Unit : mm

MODEL	PUMP														SHAFT						MASS kg	
	A	B	D	E	F	G	H	J	K	M	N	O	P	R	Z	S	Q	L	U	V		W
40X32SALE	80	355	180	230	120	22	160	37	44	260	164	40	33	150	15	24	54	40	4	7	7	39
40X32SALF	80	355	180	230	120	22	160	37	44	260	164	40	33	150	15	24	54	40	4	7	7	39
50X40SALE	100	355	180	230	120	22	160	37	44	260	164	40	29	150	15	24	54	40	4	7	7	39
50X40SALF	100	355	180	230	120	22	160	37	44	260	164	40	29	150	15	24	59	40	4	7	7	39
50X40SALG	100	375	225	260	130	22	180	37	44	290	174	39	16	155	15	32	66	50	4,5	8	10	61
65X50SALP	100	460	225	320	215	30	205	49	54	360	269	47	39	202,5	19	40	59	50	4,5	8	10	89
65X50SALG	100	460	225	320	215	30	205	49	54	360	269	47	39	202,5	19	40	59	50	4,5	8	10	89
65X50SALH	110	545	280	285	280	22	205	35	60	320	320	34	11	220	15	35	59	45	4,5	8	10	120
80X65SALF	100	460	250	320	215	30	205	47	54	360	269	60	22	202,5	19	40	59	50	4,5	8	10	92
80X65SALG	100	460	250	320	215	30	205	47	54	360	269	60	22	202,5	19	40	59	50	4,5	8	10	93
80X65SALH	120	550	280	285	280	22	205	35	60	320	320	36	0	225	15	35	59	45	4,5	8	10	130
125X100SALH	150	565	280	285	280	22	205	35	60	320	320	35	11	240	15	35	59	45	4,5	8	10	130
125X100SALJ	155	695	315	375	360	28	280	45	75	410	420	44	59	280	19	50	80	50	4,5	8	12	220
150X125SALH	180	710	355	375	360	28	280	45	75	410	420	44	45	300	19	50	80	50	4,5	8	12	280
150X125SALJ	180	710	355	375	360	28	280	45	75	410	420	44	45	300	19	50	80	50	4,5	8	12	290
200X150SALJ	220	895	400	490	440	40	350	50	85	540	490	76	86	400	24	70	107	64	6	12	18	455

Dimensions (with motor) 50Hz

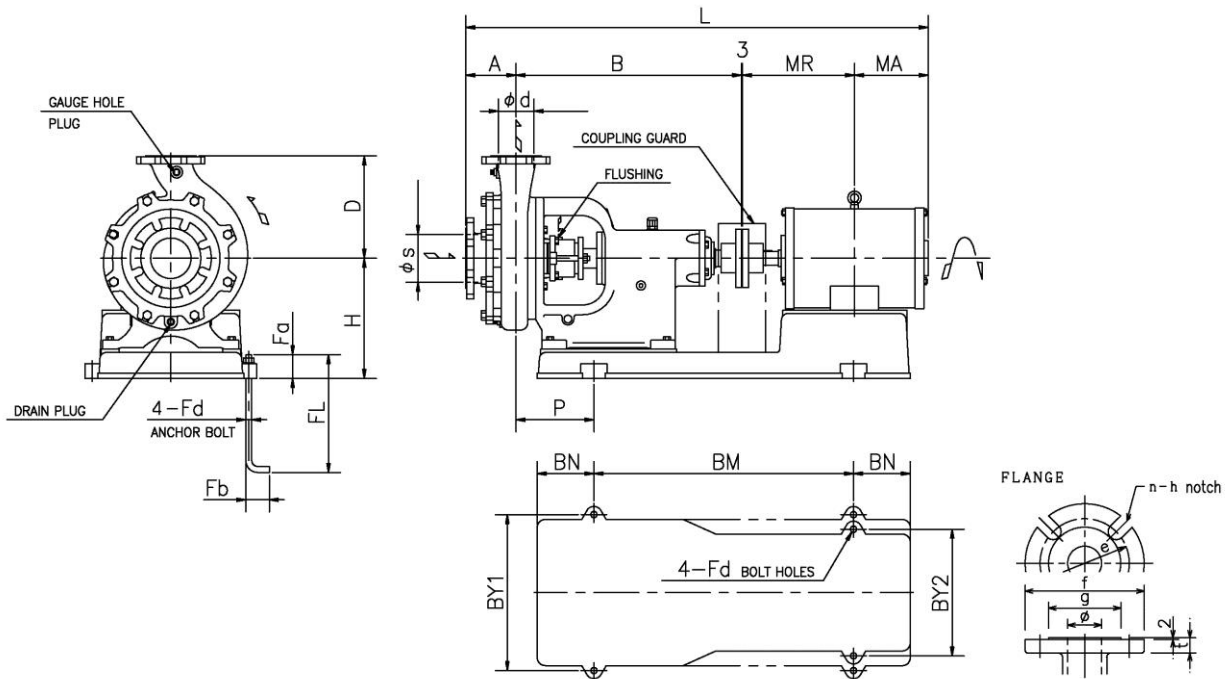

Flange (JIS10K.eq) Unit: mm

Size φ	g	e	f	t	n	h
32	80	100	135	18	4	19
40	85	105	140	18	4	19
50	100	120	155	20	4	19
65	120	140	175	22	4	19
80	130	150	185	22	8	19
100	155	175	210	24	8	19
125	185	210	250	24	8	24
150	215	240	280	26	8	24
200	265	290	330	26	12	24

50Hz

Unit: mm

Size Φs×Φd	Model	Motor output kW	Pump					Motor			Common base				Recommended foundation bolt				Mass kg	
			A	B	D	H	L	P	Frame	MA	MR	BM	BN	BY1	BY2	Fd	FL	Fa		Fb
40X32	40X32SALF5.75BL	0.75	80	355	180	225	731	160	80M	153	140	340	120	304	244	M10	200	40	40	73
	50X40SALE5.75BL	0.75	100	355	180	225	751	160	80M	153	140	340	120	304	244	M10	200	40	40	73
	50X40SALF51.5BL	1.5	100	355	180	225	827.5	160	90L	201	168.5	340	120	304	244	M10	200	40	40	80.5
50X40	50X40SALG52.2BL	2.2	100	375	225	255	870	185	100L	199	193	360	140	350	304	M12	250	55	50	117
	65X50SALF52.2BL	2.2	100	460	225	290	955	217.5	100L	199	193	380	180	410	304	M12	250	55	50	148
	65X50SALG53.7BL	3.7	100	460	225	290	975.5	217.5	112M	212.5	200	380	180	410	304	M12	250	55	50	158
65X50	65X50SALH55.5BL	5.5	110	545	280	285	1124	215	132S	227	239	380	170	390	390	M12	250	55	50	234
	80X65SALF53.7BL	3.7	100	460	250	290	975.5	217.5	112M	212.5	200	680	170	410	304	M12	250	55	50	162.5
	80X65SALG55.5BL	5.5	100	460	250	290	1029	217.5	132S	227	239	380	180	410	410	M12	250	55	50	202
80X65	80X65SALH57.5BL	7.5	120	550	280	285	1177	220	132M	246	258	540	180	390	390	M12	250	55	50	258
	80X65SALH511BL	11	120	550	280	285	1281	220	160M	285	323	680	170	390	390	M12	250	55	50	285
	80X65SALH52.2BL	2.2	120	550	280	275	1086	205	112M	212.5	200	500	155	390	310	M12	250	55	50	212.5
	125X100SALH57.5BL	7.5	150	565	280	285	1222	235	132M	246	258	680	170	390	390	M12	250	55	50	258
125X100	125X100SALH511BL	11	150	565	280	285	1326	235	160M	285	323	680	170	390	390	M12	250	55	50	285
	125X100SALH53.7BL	3.7	150	565	280	285	1222	235	132M	246	258	680	170	390	390	M12	250	55	50	242.5
	125X100SALJ515BL	15	155	695	315	370	1505	240	160L	307	345	800	175	480	390	M16	315	70	63	410
	125X100SALJ518BL	18.5	155	695	315	380	1525	265	180M	320.5	351.5	860	200	490	490	M16	315	70	63	470
	125X100SALJ55.5BL	5.5	155	695	315	370	1357	240	132M	246	258	800	175	480	390	M16	315	70	63	352.5
150X125	150X125SALH511BL	11	180	710	355	370	1501	255	160M	285	323	800	175	480	390	M16	315	70	63	440
	150X125SALH515BL	15	180	710	355	370	1545	255	160L	307	345	800	175	480	390	M16	315	70	63	465
	150X125SALH518BL	18.5	180	710	355	380	1565	255	180M	320.5	351.5	860	200	490	490	M16	315	70	63	521
	150X125SALH55.5BL	5.5	180	710	355	370	1397	255	132M	246	258	800	175	480	390	M16	315	70	63	412.5
	150X125SALJ522BL	22	180	710	355	380	1603	280	180L	339.5	370.5	860	200	490	490	M16	315	70	63	546
	150X125SALJ530BL	30	180	710	355	380	1663	280	200L	374.5	395.5	860	200	490	490	M16	315	70	63	611
	150X125SALJ537BL	37	180	710	355	380	1709	280	225S	384	432	860	200	490	490	M20	400	85	80	671
200X150	150X125SALJ57.5BL	7.5	180	710	355	370	1501	255	160M	285	323	800	175	480	390	M16	315	70	63	455
	150X125SALJ511BL	11	180	710	355	370	1545	255	160L	307	345	800	175	480	390	M16	315	70	63	490
	200X150SALJ530BL	30	220	895	400	460	1888	350	200L	374.5	395.5	960	220	640	500	M16	315	70	63	818
	200X150SALJ537BL	37	220	895	400	460	1934	350	225S	384	432	960	220	640	500	M16	315	70	63	878
	200X150SALJ545BL	45	220	895	400	460	1959	350	225M	396.5	444.5	960	220	640	500	M16	315	70	63	893
	200X150SALJ555BL	55	220	895	400	460	2039	350	250M	438.5	482.5	1040	240	640	640	M20	400	85	80	1043
200X150	200X150SALJ511BL	11	220	895	400	460	1770	350	160L	307	345	960	220	640	500	M16	315	70	63	703
	200X150SALJ515BL	15	220	895	400	460	1828	350	180L	339.5	370.5	960	220	640	500	M16	315	70	63	758

The above dimensions change depending on the electric motor used.

6Pole

EBARA END SUCTION VOLUTE PUMPS

PERFORMANCE CURVE

MODEL 40X32SALF5.75BL FREQUENCY 50 Hz OUTPUT 0.75 kW

MOTOR RATING POLES 4 P SPEED 1440 min⁻¹ OUTPUT 0.75 kW

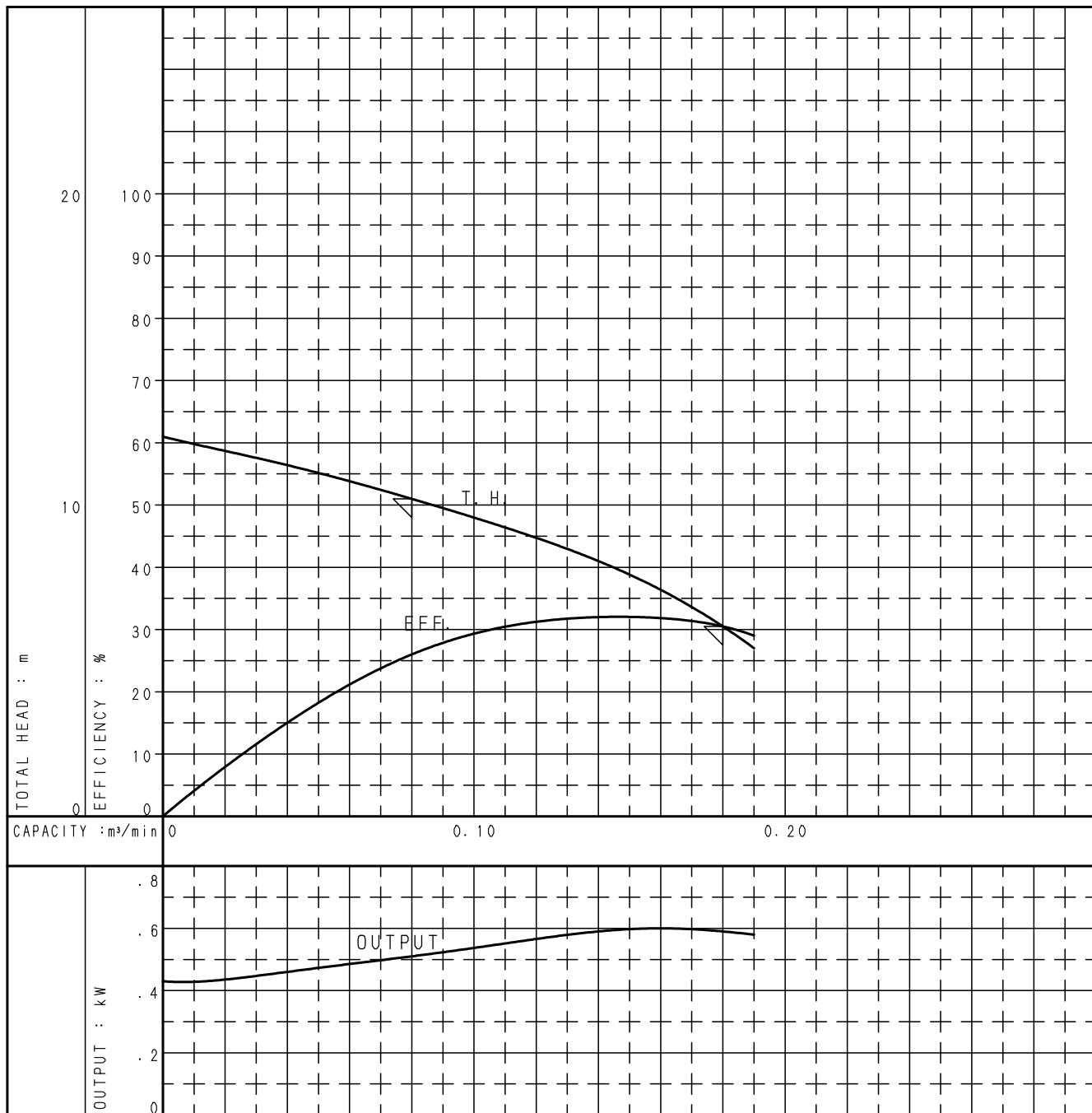

NOTE This curve is based on JIS testing code (B8301, B8302).

190

CASING TEST PRESS.

0.60 MPa

CUSTOMER			ITEM NO.			
FINAL USER			ITEM NAME			
SER. NO.	MODEL	CAPACITY	TOTAL HEAD	SPEED	OUTPUT	Q' TY
				min ⁻¹		

DWG. NO. C40X32SALF5.75BL 000

C40X32SALF5.75BL

160419

EBARA END SUCTION VOLUTE PUMPS

PERFORMANCE CURVE

MODEL 50X40SALE5.75BL FREQUENCY 50 Hz OUTPUT 0.75 kW

MOTOR RATING POLES 4 P SPEED 1440 min⁻¹ OUTPUT 0.75 kW

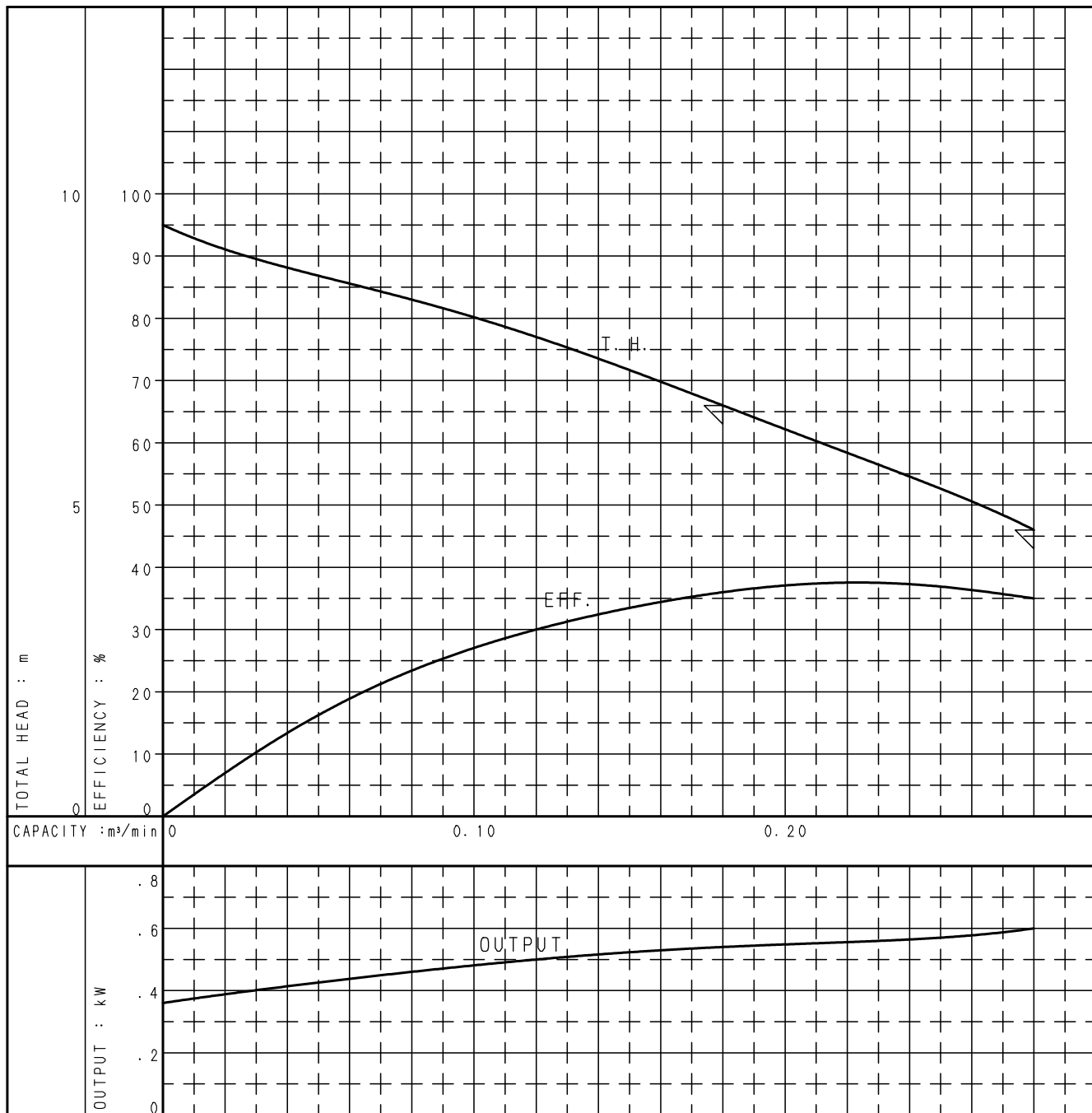

NOTE This curve is based on JIS testing code (B8301, B8302).

173

CASING TEST PRESS.

0.60 MPa

CUSTOMER			ITEM NO.			
FINAL USER			ITEM NAME			
SER. NO.	MODEL	CAPACITY	TOTAL HEAD	SPEED	OUTPUT	Q' TY
				min ⁻¹		

DWG. NO. C50X40SALE5.75BL 000

C50X40SALE5.75BL

160419

EBARA END SUCTION VOLUTE PUMPS

PERFORMANCE CURVE

MODEL 50X40SALF51.5BL FREQUENCY 50 Hz OUTPUT 1.5 kW

MOTOR RATING POLES 4 P SPEED 1445 min⁻¹ OUTPUT 1.5 kW

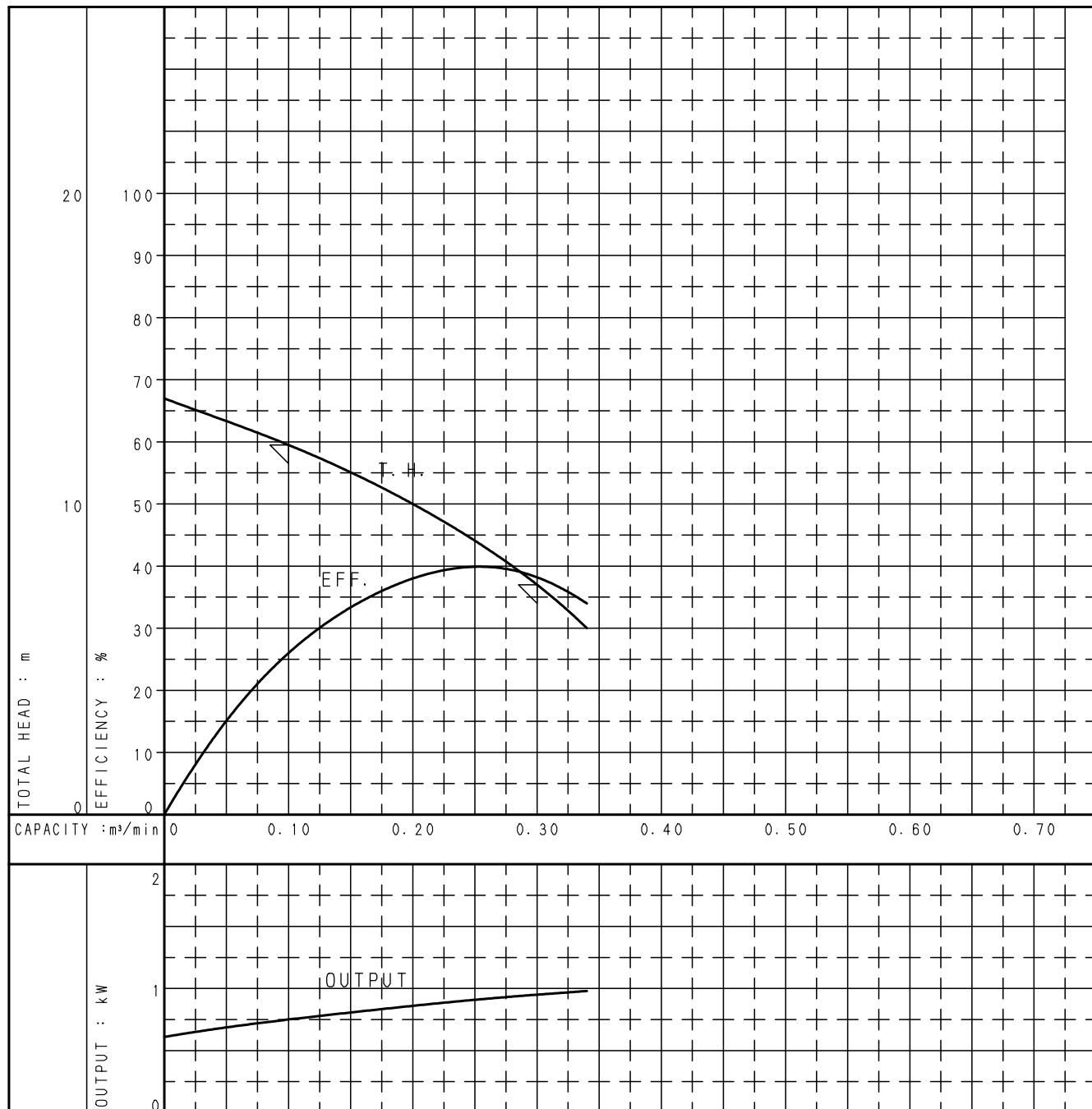

NOTE This curve is based on JIS testing code (B8301, B8302).

197

CASING TEST PRESS.

0.60 MPa

CUSTOMER			ITEM NO.			
FINAL USER			ITEM NAME			
SER. NO.	MODEL	CAPACITY	TOTAL HEAD	SPEED	OUTPUT	Q' TY
				min ⁻¹		

DWG. NO. C50X40SALF51.5BL 000

C50X40SALF51.5BL

160419

EBARA END SUCTION VOLUTE PUMPS

PERFORMANCE CURVE

MODEL 50X40SALG52.2BL FREQUENCY 50 Hz OUTPUT 2.2 kW

MOTOR RATING POLES 4 P SPEED 1460 min⁻¹ OUTPUT 2.2 kW

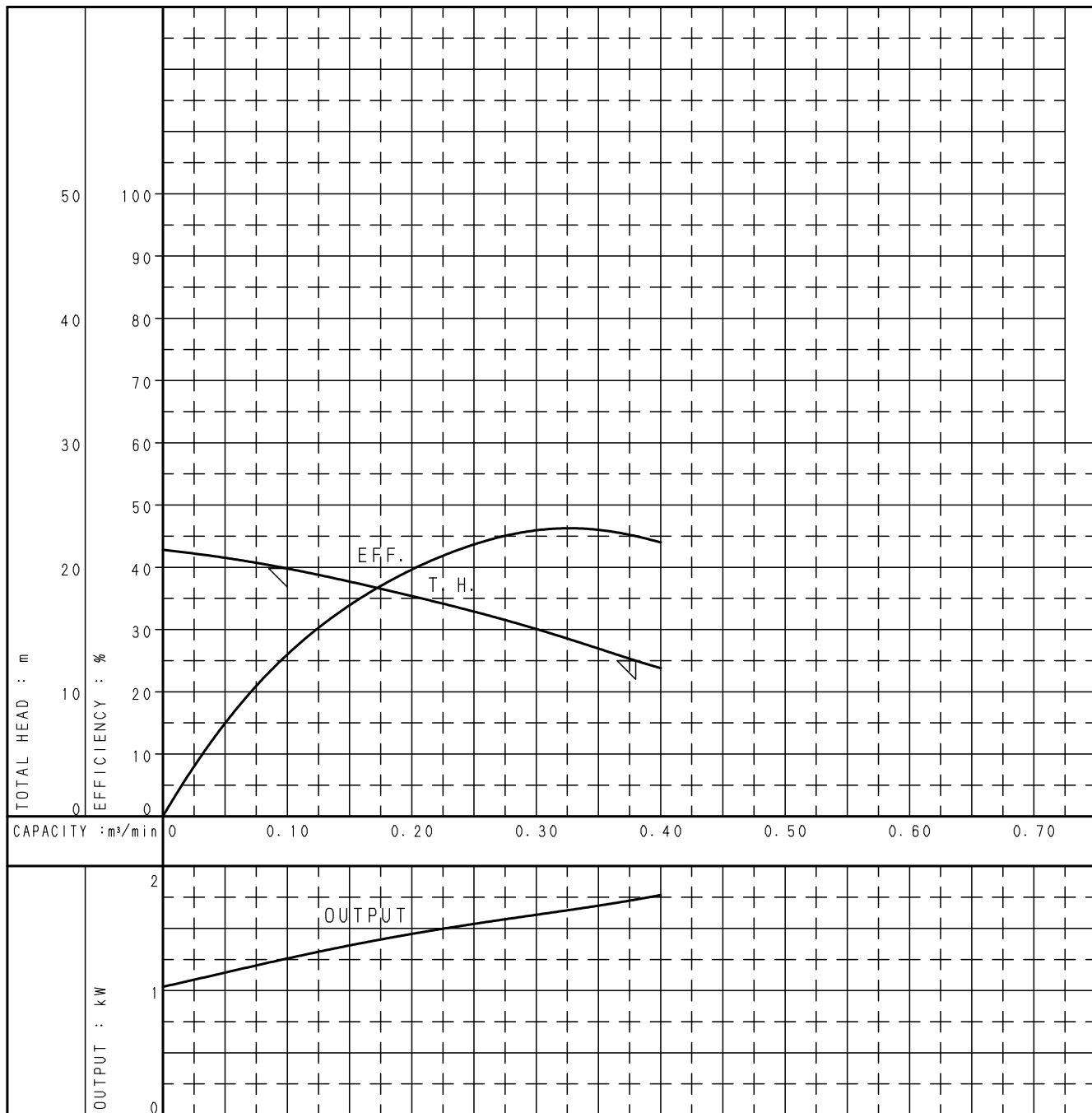

NOTE This curve is based on JIS testing code (B8301, B8302).

246

CASING TEST PRESS.

0.85 MPa

CUSTOMER			ITEM NO.			
FINAL USER			ITEM NAME			
SER. NO.	MODEL	CAPACITY	TOTAL HEAD	SPEED	OUTPUT	Q' TY
				min ⁻¹		

DWG. NO. C50X40SALG52.2BL 000

C50X40SALG52.2BL

160419

EBARA END SUCTION VOLUTE PUMPS

PERFORMANCE CURVE

MODEL 65X50SALF52.2BL FREQUENCY 50 Hz OUTPUT 2.2 kW

MOTOR RATING POLES 4 P SPEED 1460 min⁻¹ OUTPUT 2.2 kW

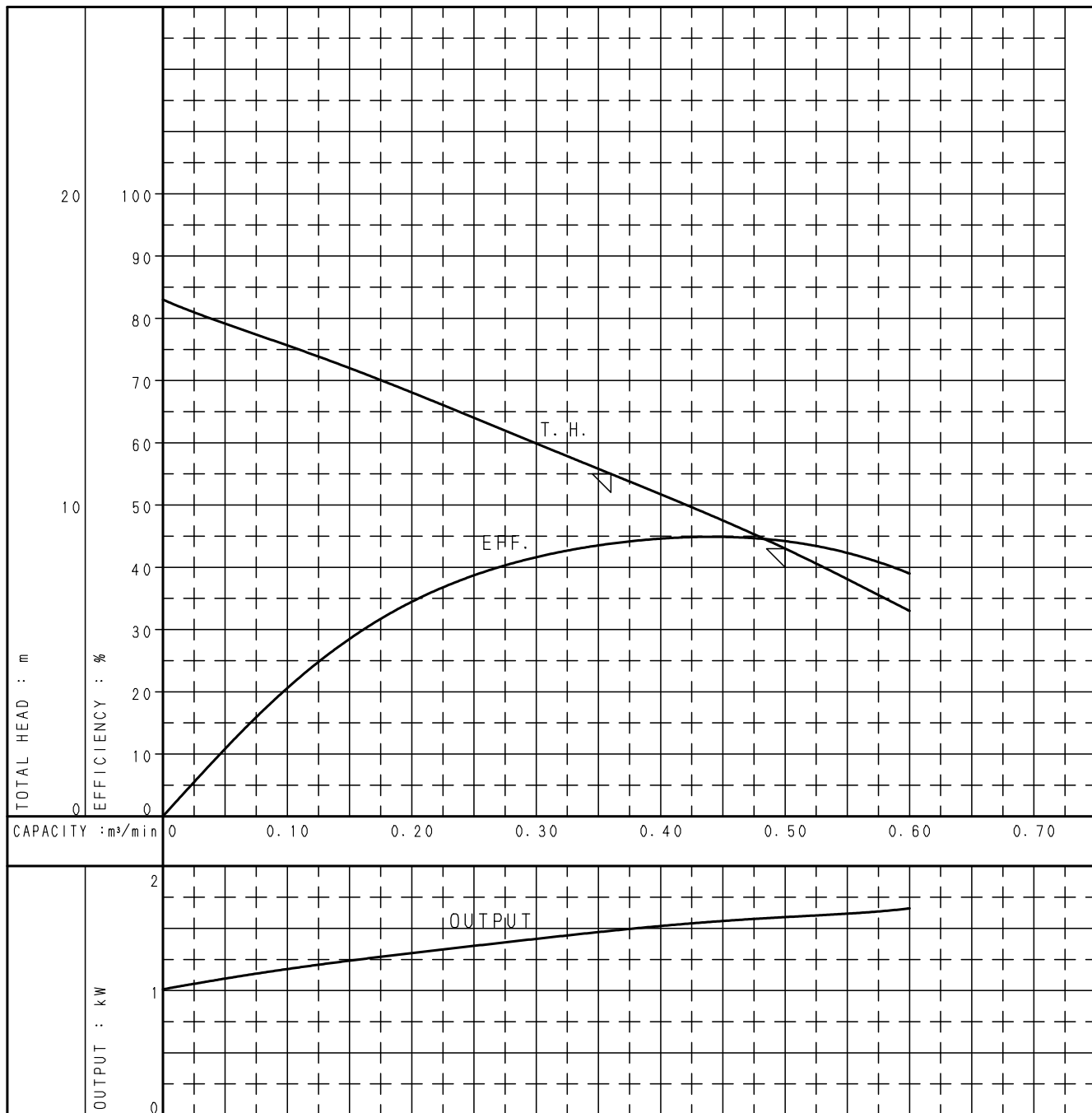

NOTE This curve is based on JIS testing code (B8301, B8302).

228

CASING TEST PRESS.

0.85 MPa

CUSTOMER			ITEM NO.			
FINAL USER			ITEM NAME			
SER. NO.	MODEL	CAPACITY	TOTAL HEAD	SPEED	OUTPUT	Q' TY
				min ⁻¹		

DWG. NO. C65X50SALF52.2BL 000

C65X50SALF52.2BL

160419

EBARA END SUCTION VOLUTE PUMPS

PERFORMANCE CURVE

MODEL 65X50SALG53.7BL FREQUENCY 50 Hz OUTPUT 3.7 kW

MOTOR RATING POLES 4 P SPEED 1460 min⁻¹ OUTPUT 3.7 kW

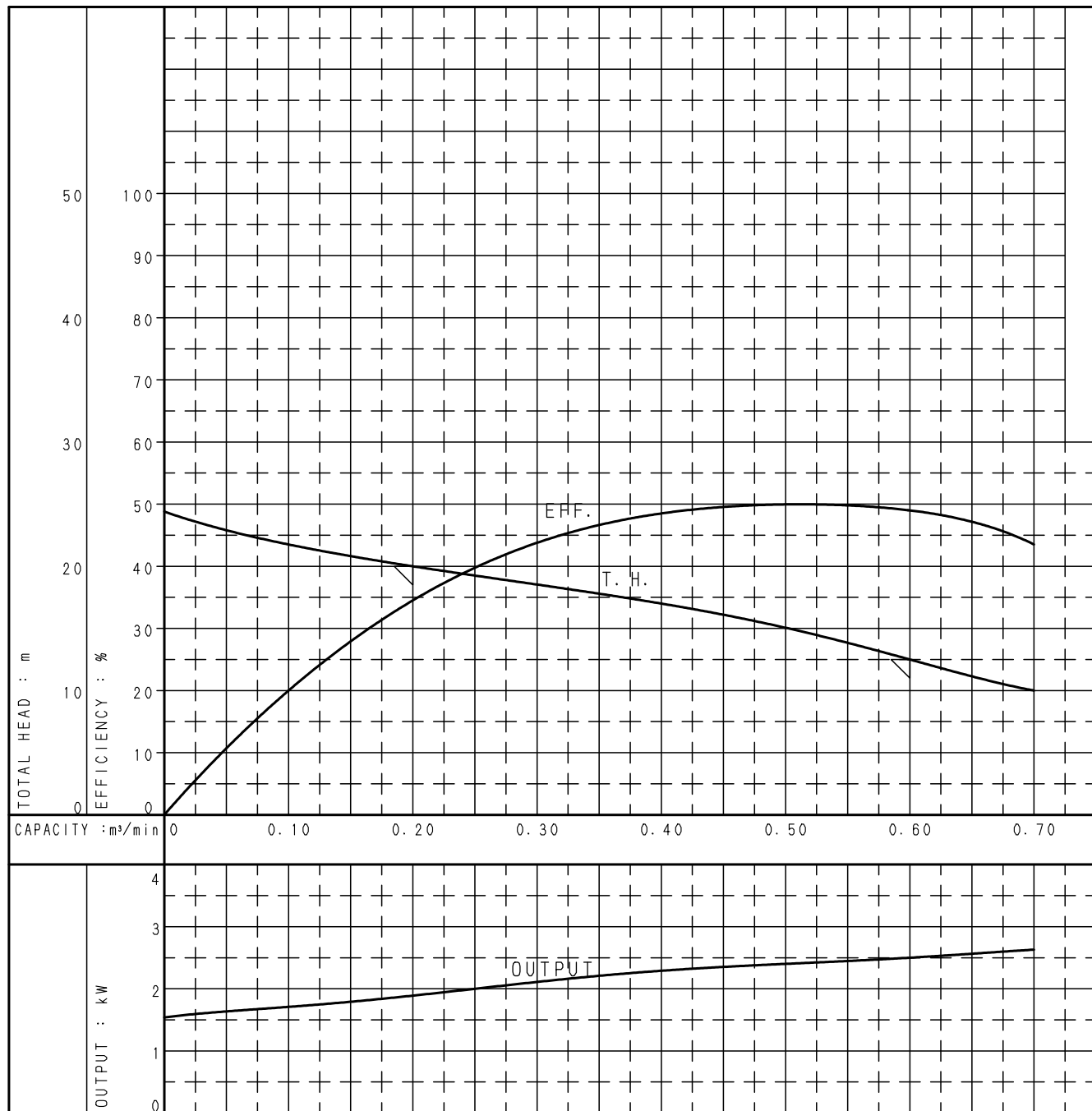

NOTE This curve is based on JIS testing code (B8301, B8302).

258

CASING TEST PRESS.

0.85 MPa

CUSTOMER			ITEM NO.			
FINAL USER			ITEM NAME			
SER. NO.	MODEL	CAPACITY	TOTAL HEAD	SPEED	OUTPUT	Q' TY
				min ⁻¹		

DWG. NO. C65X50SALG53.7BL 000

C65X50SALG53.7BL

160419

EBARA END SUCTION VOLUTE PUMPS

PERFORMANCE CURVE

MODEL **65X50SALH55.5BL** FREQUENCY **50 Hz** OUTPUT **5.5 kW**

MOTOR RATING POLES 4 P SPEED 1465 min⁻¹ OUTPUT 5.5 kW

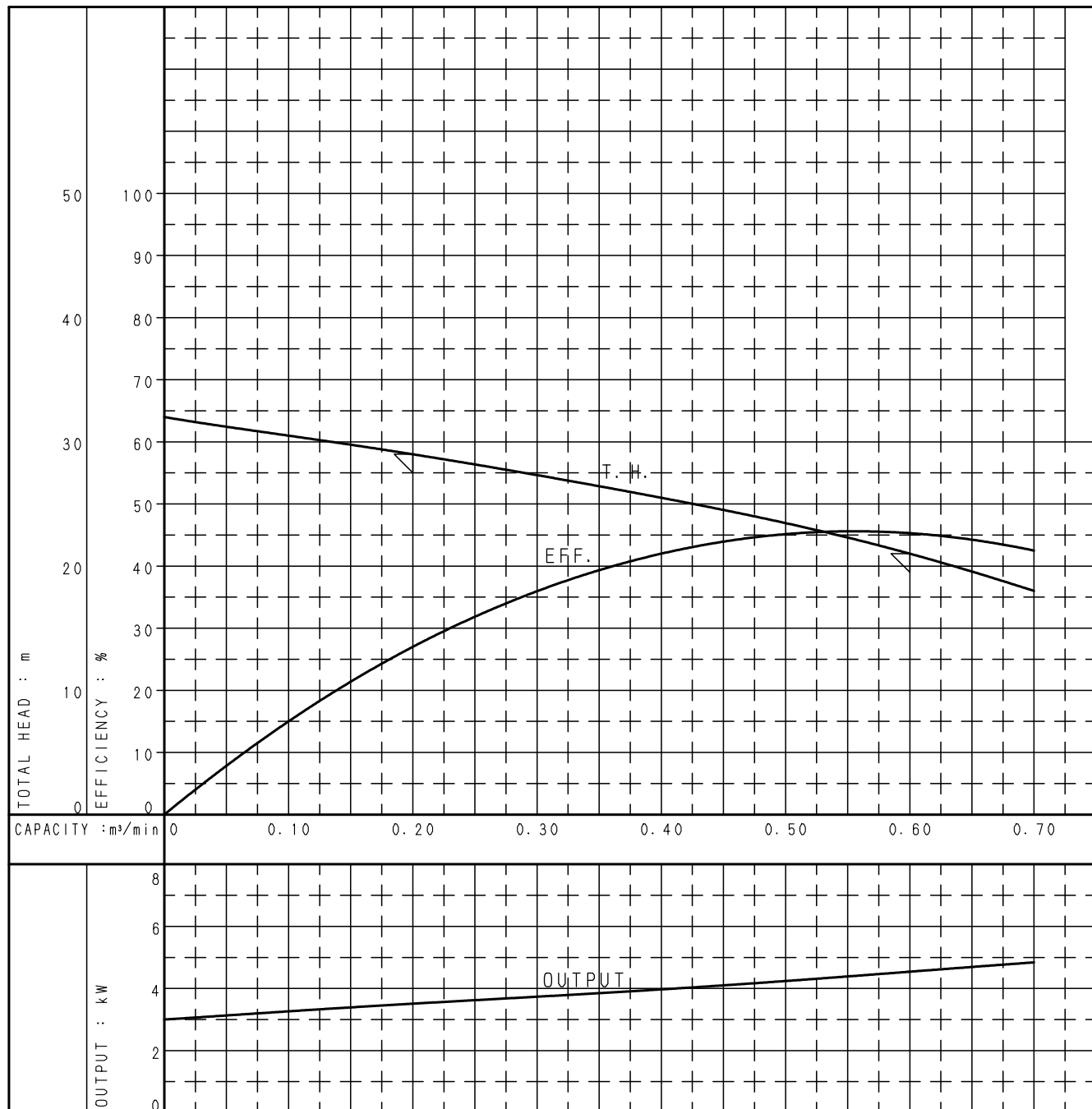

NOTE This curve is based on JIS testing code (B8301, B8302).

306

CASING TEST PRESS.

1.00 MPa

CUSTOMER			ITEM NO.			
FINAL USER			ITEM NAME			
SER. NO.	MODEL	CAPACITY	TOTAL HEAD	SPEED	OUTPUT	Q' TY
				min ⁻¹		

DWG. NO. C65X50SALH55.5BL 000

C65X50SALH55.5BL

160419

EBARA END SUCTION VOLUTE PUMPS

PERFORMANCE CURVE

MODEL 80X65SALF53.7BL FREQUENCY 50 Hz OUTPUT 3.7 kW

MOTOR RATING POLES 4 P SPEED 1460 min⁻¹ OUTPUT 3.7 kW

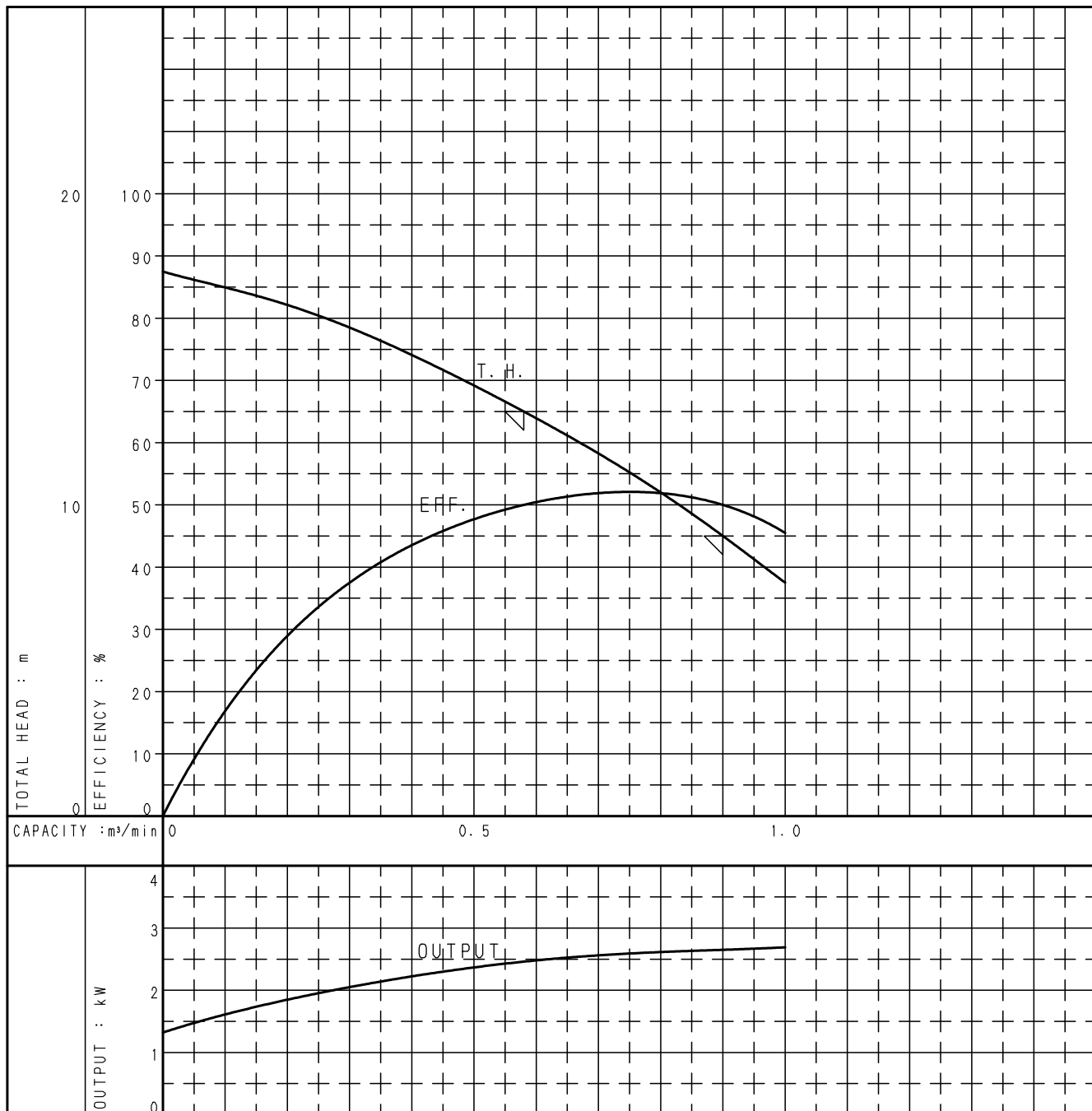

NOTE This curve is based on JIS testing code (B8301, B8302).

230

CASING TEST PRESS.

0.85 MPa

CUSTOMER			ITEM NO.			
FINAL USER			ITEM NAME			
SER. NO.	MODEL	CAPACITY	TOTAL HEAD	SPEED	OUTPUT	Q' TY
				min ⁻¹		

DWG. NO. C80X65SALF53.7BL 000

C80X65SALF53.7BL

160427

EBARA END SUCTION VOLUTE PUMPS

PERFORMANCE CURVE

MODEL 80X65SALG55.5BL FREQUENCY 50 Hz OUTPUT 5.5 kW

MOTOR RATING POLES 4 P SPEED 1465 min⁻¹ OUTPUT 5.5 kW

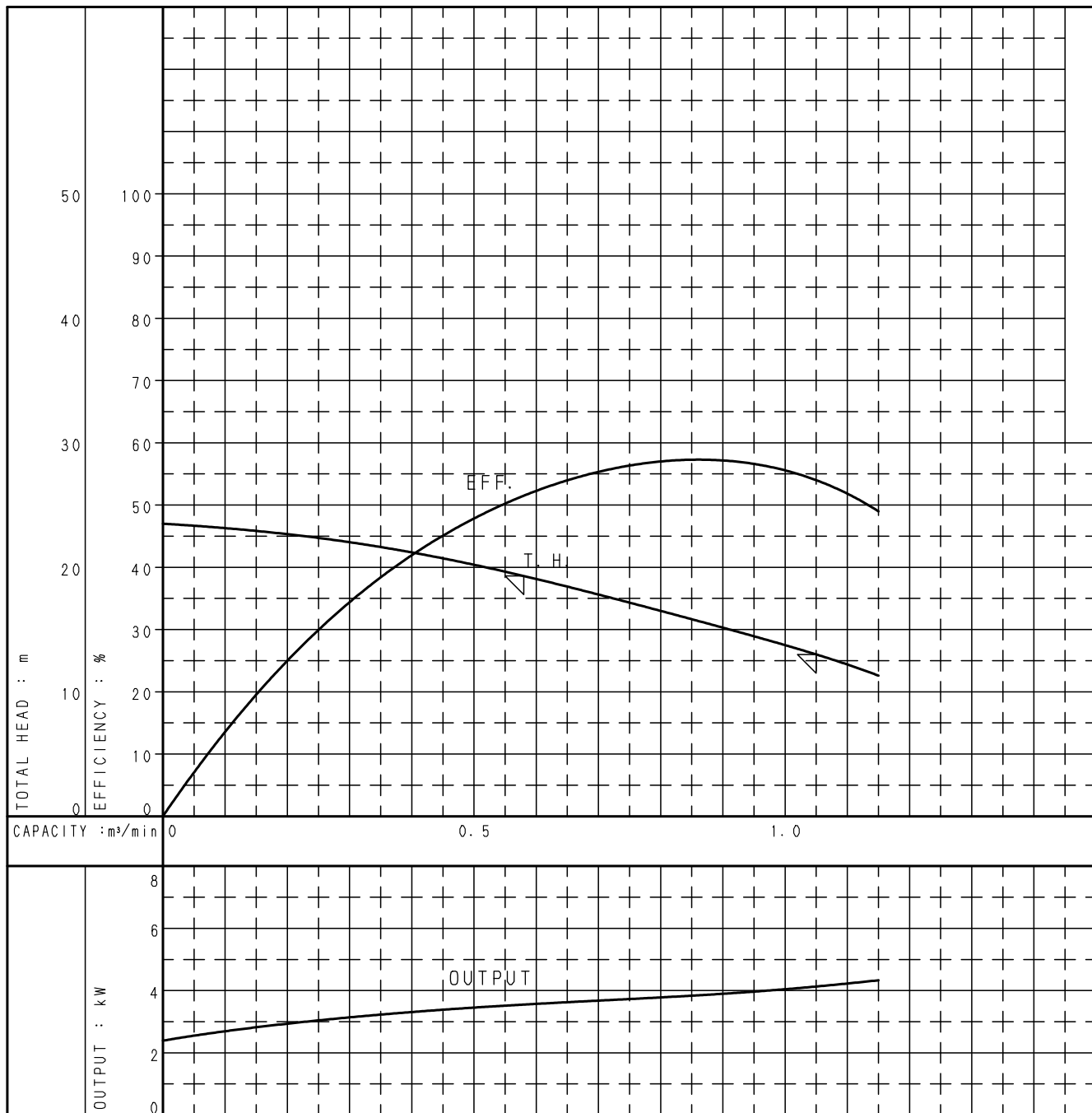

NOTE This curve is based on JIS testing code (B8301, B8302).

258

CASING TEST PRESS.

0.85 MPa

CUSTOMER			ITEM NO.			
FINAL USER			ITEM NAME			
SER. NO.	MODEL	CAPACITY	TOTAL HEAD	SPEED	OUTPUT	Q' TY
				min ⁻¹		

DWG. NO. C80X65SALG55.5BL 000

C80X65SALG55.5BL

160427

EBARA END SUCTION VOLUTE PUMPS

PERFORMANCE CURVE

MODEL 80X65SALH57.5BL FREQUENCY 50 Hz OUTPUT 7.5 kW

MOTOR RATING POLES 4 P SPEED 1460 min⁻¹ OUTPUT 7.5 kW

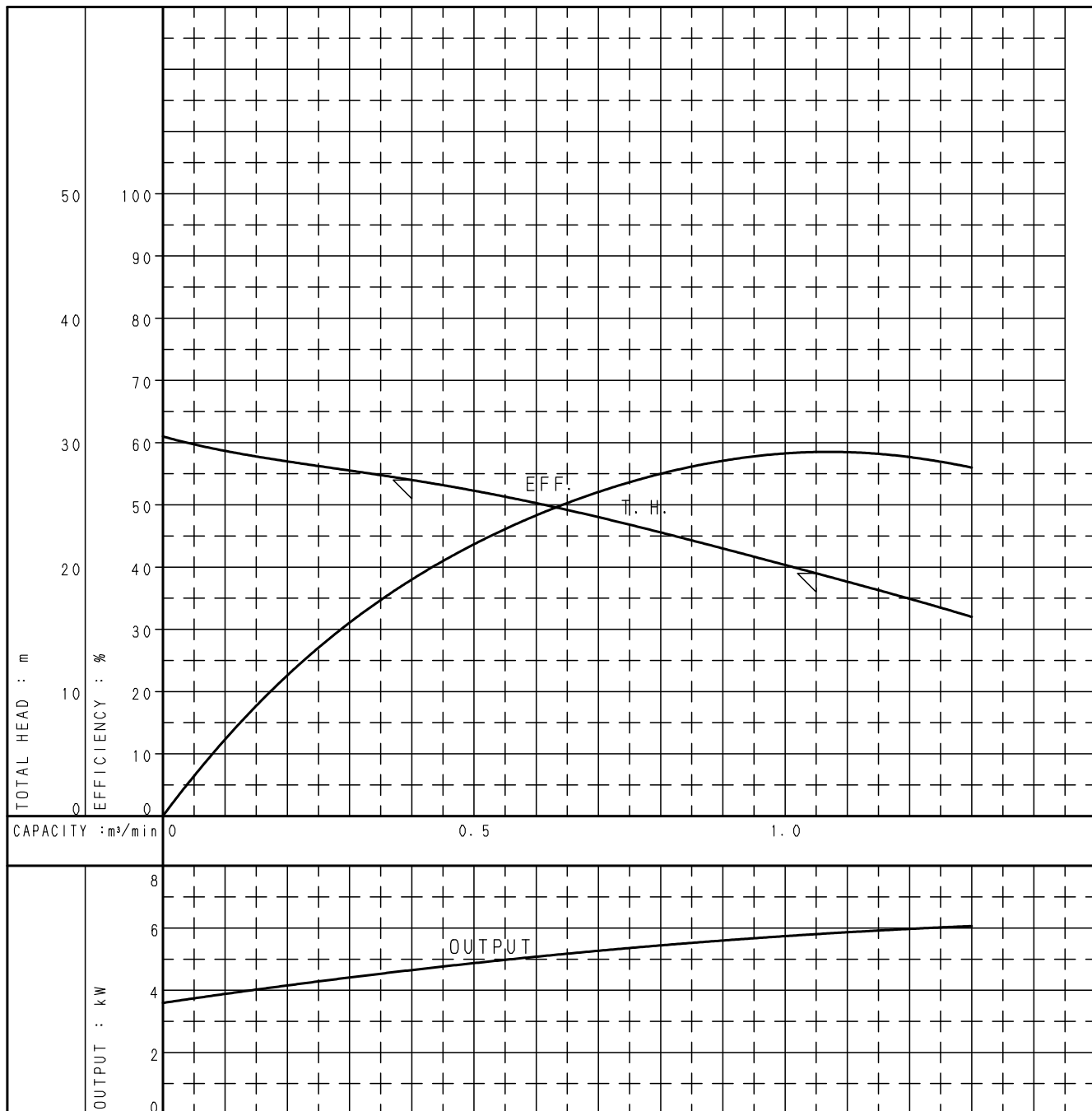

NOTE This curve is based on JIS testing code (B8301, B8302).

288

CASING TEST PRESS.

1.00 MPa

CUSTOMER			ITEM NO.			
FINAL USER			ITEM NAME			
SER. NO.	MODEL	CAPACITY	TOTAL HEAD	SPEED	OUTPUT	Q' TY
				min ⁻¹		

DWG. NO. C80X65SALH57.5BL 000

C80X65SALH57.5BL

160427

EBARA END SUCTION VOLUTE PUMPS

PERFORMANCE CURVE

MODEL 80X65SALH511BL FREQUENCY 50 Hz OUTPUT 11 kW

MOTOR RATING POLES 4 P SPEED 1475 min⁻¹ OUTPUT 11kW

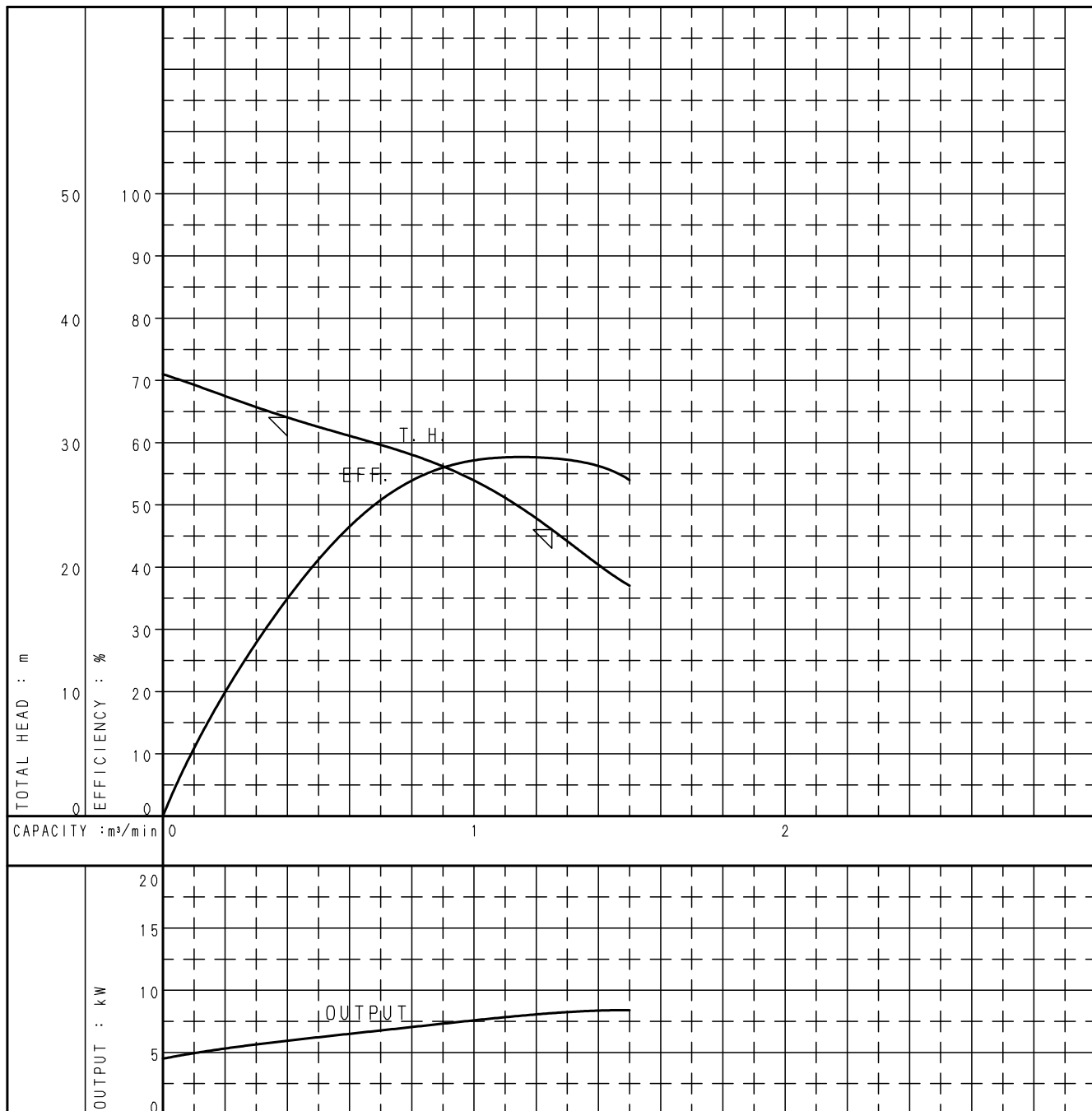

NOTE This curve is based on JIS testing code (B8301, B8302).

314

CASING TEST PRESS.

1.00 MPa

CUSTOMER			ITEM NO.			
FINAL USER			ITEM NAME			
SER. NO.	MODEL	CAPACITY	TOTAL HEAD	SPEED	OUTPUT	Q' TY
				min ⁻¹		

DWG. NO. C80X65SALH511BL 000

C80X65SALH511BL

160427

EBARA END SUCTION VOLUTE PUMPS

PERFORMANCE CURVE

MODEL 125X100SALH57.5BL FREQUENCY 50 Hz OUTPUT 7.5 kW

MOTOR RATING POLES 4 P SPEED 1460 min⁻¹ OUTPUT 7.5 kW

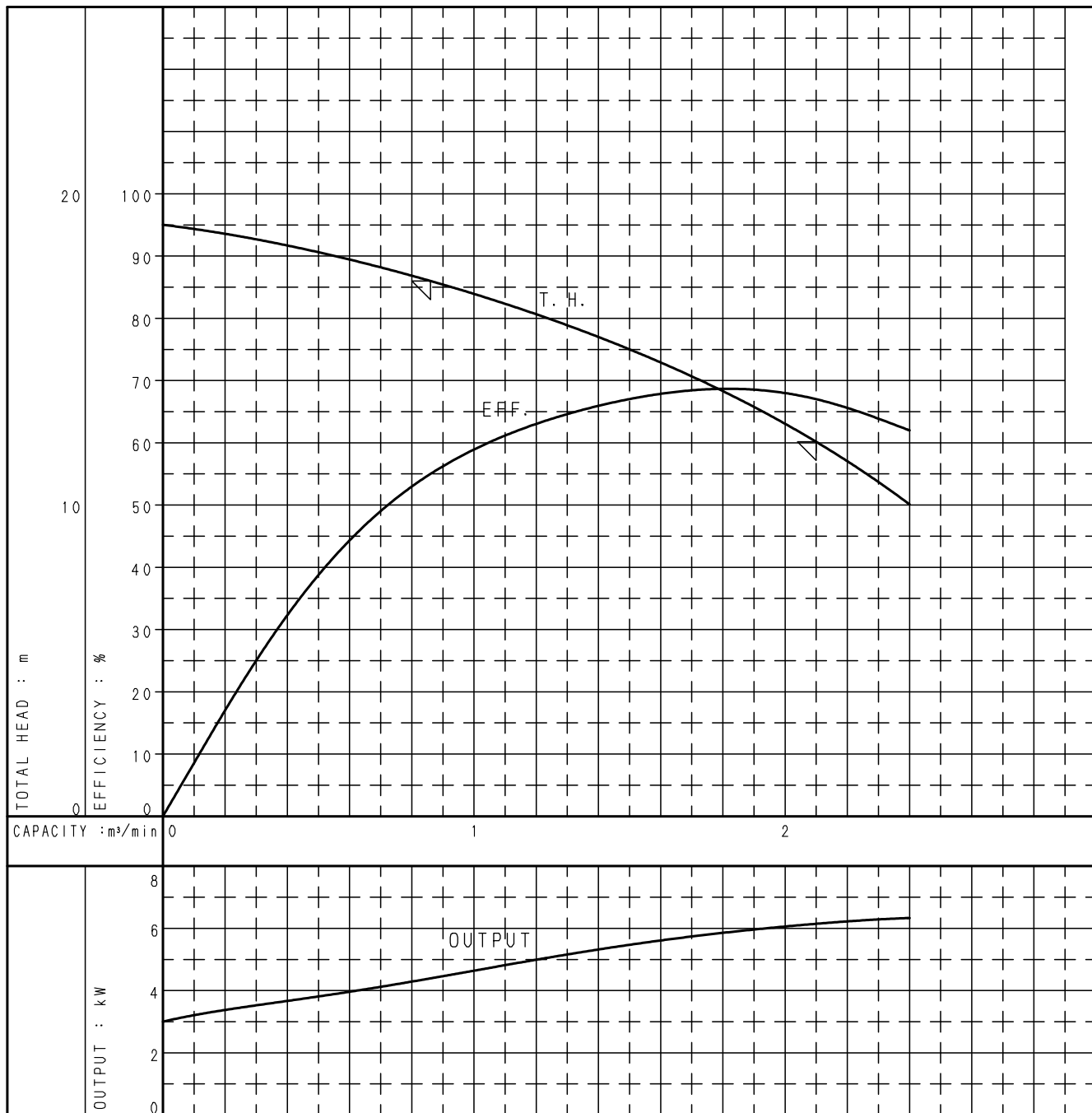

NOTE This curve is based on JIS testing code (B8301, B8302).

234

CASING TEST PRESS.

1.00 MPa

CUSTOMER			ITEM NO.			
FINAL USER			ITEM NAME			
SER. NO.	MODEL	CAPACITY	TOTAL HEAD	SPEED	OUTPUT	Q' TY
				min ⁻¹		

DWG. NO. C12510SALH57.5BL 000

C12510SALH57.5BL

160427

EBARA END SUCTION VOLUTE PUMPS

PERFORMANCE CURVE

MODEL 125X100SALH511BL FREQUENCY 50 Hz OUTPUT 11 kW

MOTOR RATING POLES 4 P SPEED 1475 min⁻¹ OUTPUT 11kW

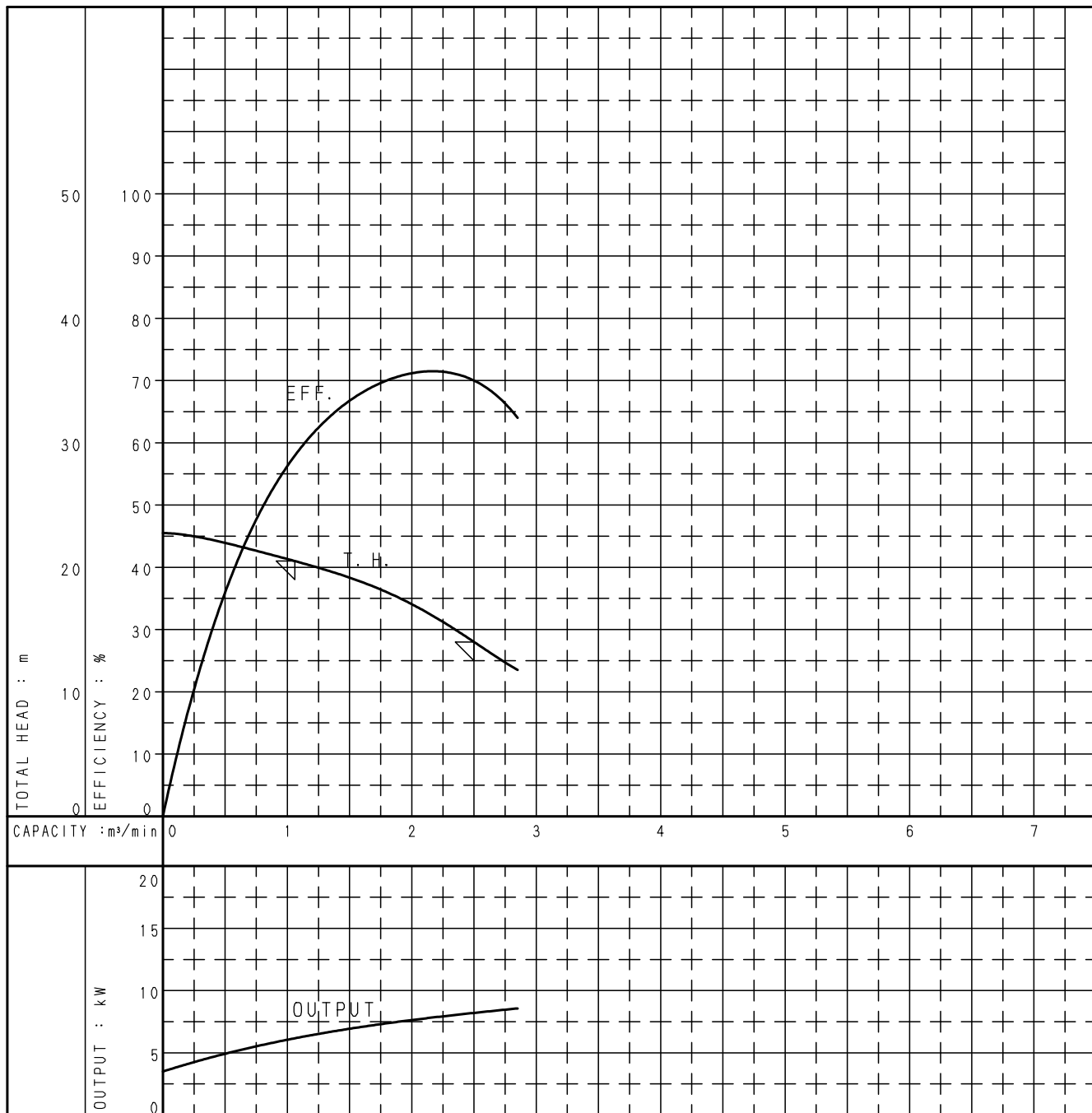

NOTE This curve is based on JIS testing code (B8301, B8302).

257

CASING TEST PRESS.

1.00 MPa

CUSTOMER			ITEM NO.			
FINAL USER			ITEM NAME			
SER. NO.	MODEL	CAPACITY	TOTAL HEAD	SPEED	OUTPUT	Q' TY
				min ⁻¹		

DWG. NO. C125100SALH511BL 000

C125100SALH511BL

160427

EBARA END SUCTION VOLUTE PUMPS

PERFORMANCE CURVE

MODEL 125X100SALJ515BL FREQUENCY 50 Hz OUTPUT 15 kW

MOTOR RATING POLES 4 P SPEED 1470 min⁻¹ OUTPUT 15 kW

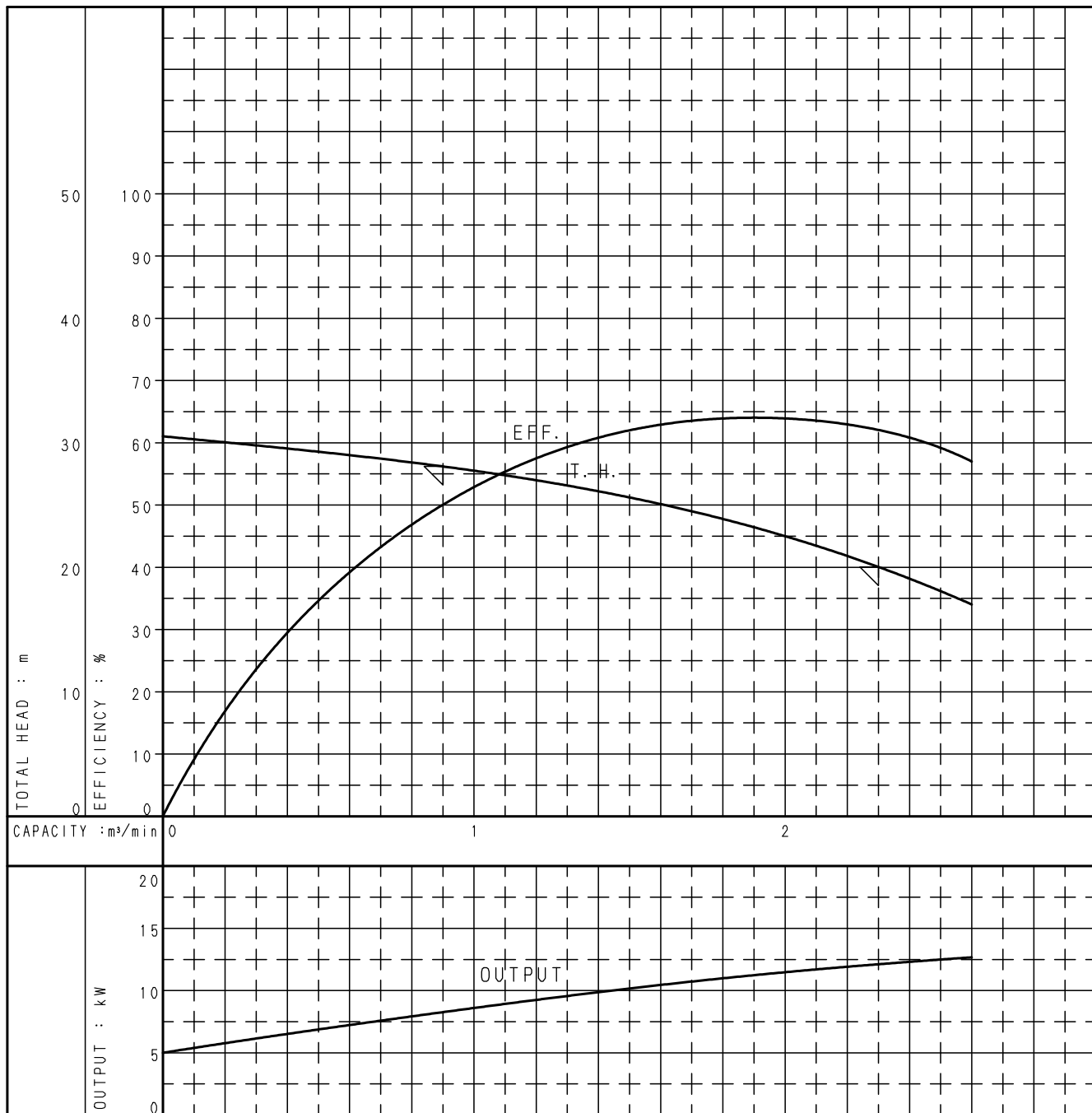

NOTE This curve is based on JIS testing code (B8301, B8302).

310

CASING TEST PRESS.

1.00 MPa

CUSTOMER			ITEM NO.			
FINAL USER			ITEM NAME			
SER. NO.	MODEL	CAPACITY	TOTAL HEAD	SPEED	OUTPUT	Q' TY
				min ⁻¹		

DWG. NO. C125100SALJ515BL 000

C125100SALJ515BL

160427

EBARA END SUCTION VOLUTE PUMPS

PERFORMANCE CURVE

MODEL 125X100SALJ518BL FREQUENCY 50 Hz OUTPUT 18.5 kW

MOTOR RATING POLES 4 P SPEED 1475 min⁻¹ OUTPUT 18.5 kW

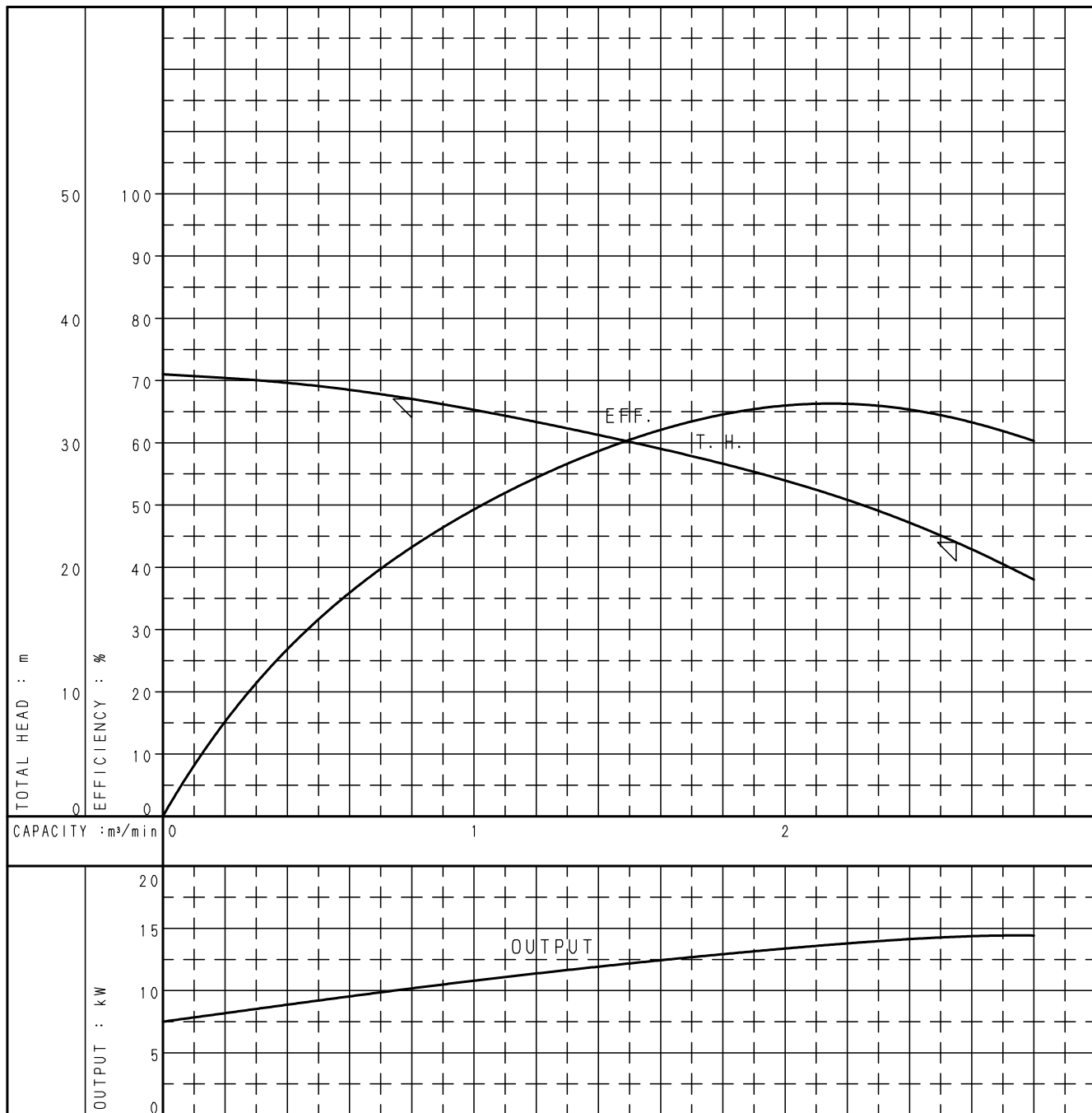

NOTE This curve is based on JIS testing code (B8301, B8302).

314

CASING TEST PRESS.

1.00 MPa

CUSTOMER			ITEM NO.			
FINAL USER			ITEM NAME			
SER. NO.	MODEL	CAPACITY	TOTAL HEAD	SPEED	OUTPUT	Q' TY
				min ⁻¹		

DWG. NO. C125100SALJ518BL 000

C125100SALJ518BL

160427

EBARA END SUCTION VOLUTE PUMPS

PERFORMANCE CURVE

MODEL 80X65SALH52.2BL FREQUENCY 50 Hz OUTPUT 2.2 kW

MOTOR RATING POLES 6 P SPEED 955 min⁻¹ OUTPUT 2.2 kW

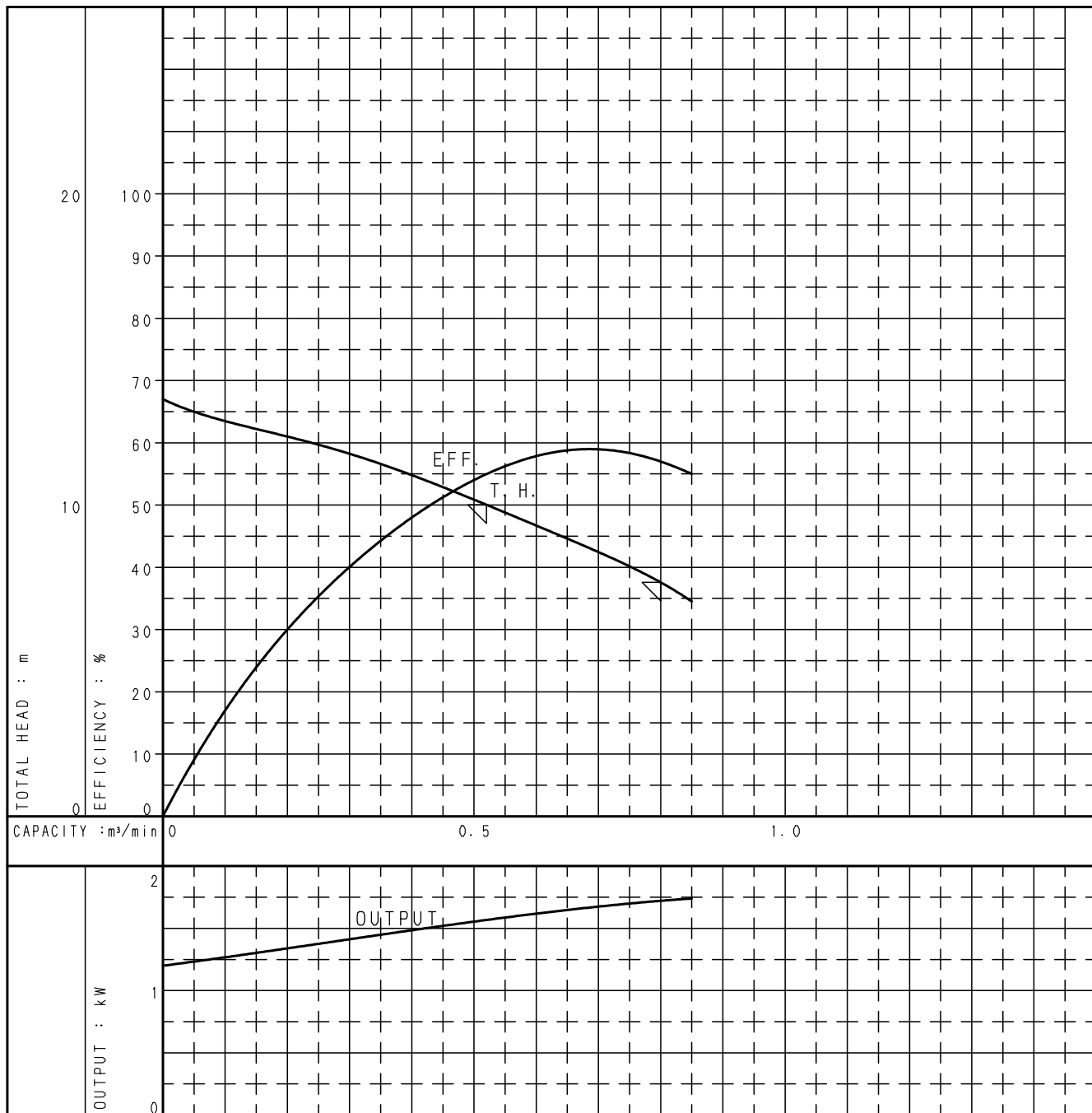

NOTE This curve is based on JIS testing code (B8301, B8302).

288

CASING TEST PRESS.

1.00 MPa

CUSTOMER			ITEM NO.			
FINAL USER			ITEM NAME			
SER. NO.	MODEL	CAPACITY	TOTAL HEAD	SPEED	OUTPUT	Q' TY
				min ⁻¹		

DWG. NO. C80X65SALH52.2BL 000

C80X65SALH52.2BL

160427

EBARA END SUCTION VOLUTE PUMPS

PERFORMANCE CURVE

MODEL 125X100SALH53.7BL FREQUENCY 50 Hz OUTPUT 3.7 kW

MOTOR RATING POLES 6 P SPEED 965 min⁻¹ OUTPUT 3.7 kW

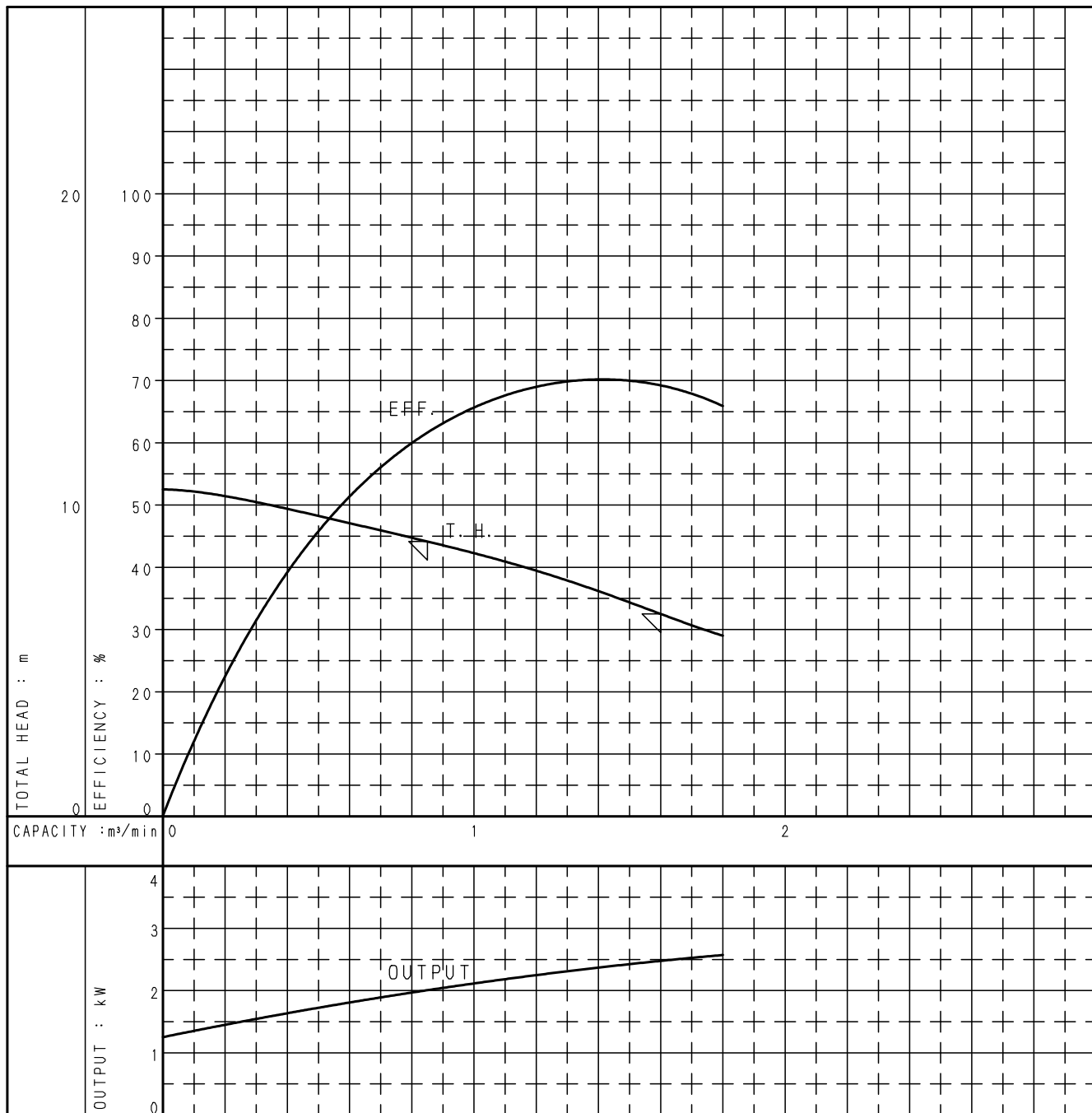

NOTE This curve is based on JIS testing code (B8301, B8302).

257

CASING TEST PRESS.

1.00 MPa

CUSTOMER		ITEM NO.				
FINAL USER		ITEM NAME				
SER. NO.	MODEL	CAPACITY	TOTAL HEAD	SPEED	OUTPUT	Q' TY
				min ⁻¹		

DWG. NO. C12510SALH53.7BL 000

C12510SALH53.7BL

160427

EBARA END SUCTION VOLUTE PUMPS

PERFORMANCE CURVE

MODEL 125X100SALJ55.5BL FREQUENCY 50 Hz OUTPUT 5.5 kW

MOTOR RATING POLES 6 P SPEED 965 min⁻¹ OUTPUT 5.5 kW

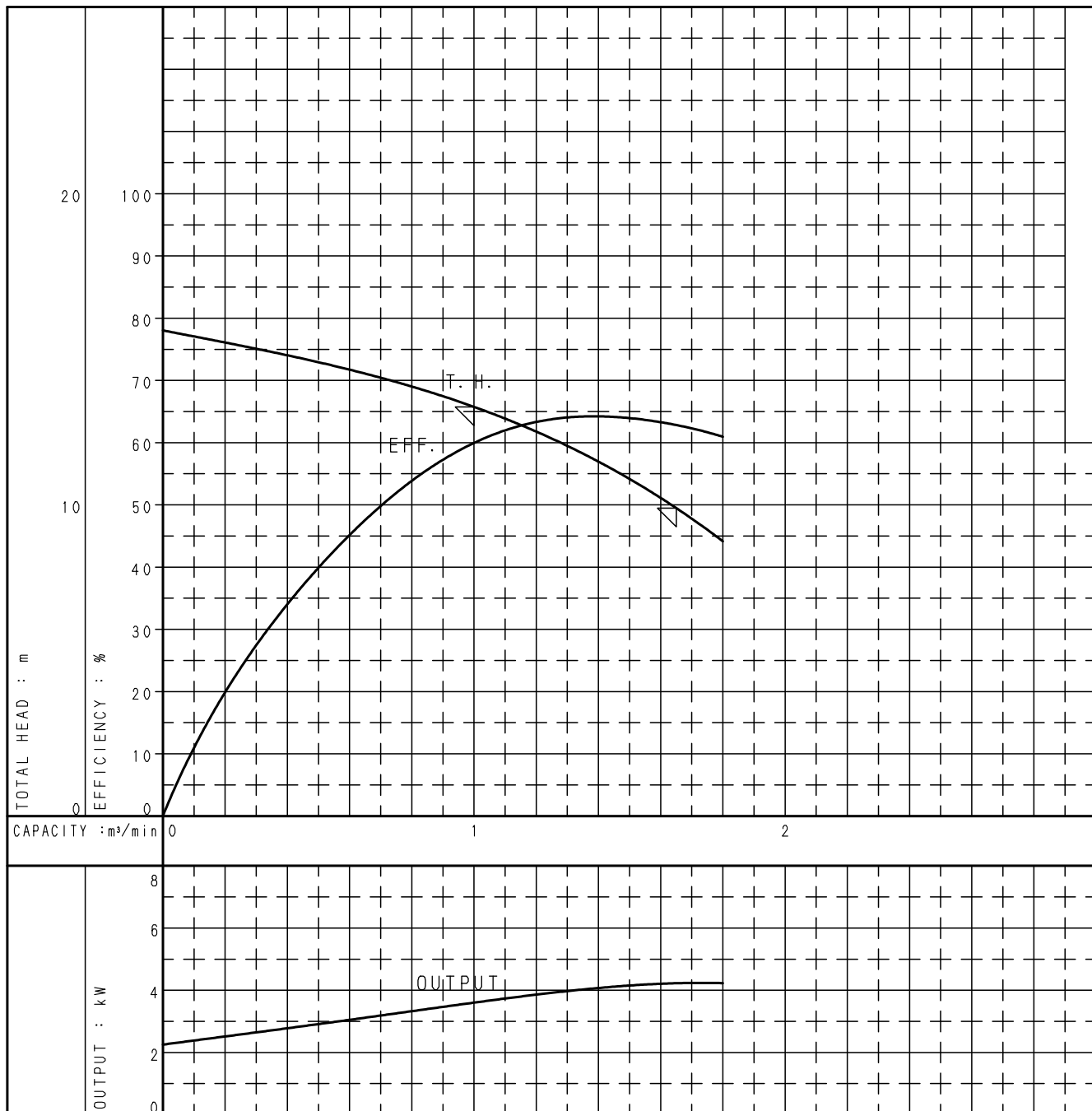

NOTE This curve is based on JIS testing code (B8301, B8302).

314

CASING TEST PRESS.

1.00 MPa

CUSTOMER			ITEM NO.			
FINAL USER			ITEM NAME			
SER. NO.	MODEL	CAPACITY	TOTAL HEAD	SPEED	OUTPUT	Q' TY
				min ⁻¹		

DWG. NO. C12510SALJ55.5BL 000

C12510SALJ55.5BL

160427



EBARA CORPORATION <https://www.ebara.co.jp>

11-1, Haneda Asahi-cho, Ohta-ku, Tokyo 144-8510, Japan

Haneda Head
Office, Tokyo



EBARA GLOBAL NETWORK

■ Ebara International Corporation

350 Salomon Circle, Sparks, NV 89434, U.S.A.
Phone 1-775-356-2796 Fax 1-775-356-2884

■ Ebara Industrias Mecanicas e Comercio Ltda.

Rua Joaquim Marques de Figueiredo 2-31, CEP 17034-290 Bauru S.P., Brazil
Phone 55-14-4009-0000 Fax 55-14-4009-0044

■ Ebara Pumps Europe S.p.A.

Via Campo Sportivo 30, 38023, Cles(Trento), Italy
Phone 39-0463-660411 Fax 39-0463-422782

■ Ebara Espana Bombas S.A.

C/Cormoranes nR 6y8, Poligono Industrial La Estacion, 28320, Pinto(Madrid), Spain
Phone 34-91-692-3630 Fax 34-91-691-0818

■ Ebara Pumps Middle East FZE

P.O.BOX61383 Jebel Ali, Dubai, UAE
Phone 971-4-883-8889

■ Ebara Pumps Australia Pty. Ltd.

7 Holloway Drive Bayswater, Victoria 3153, Australia
Phone 61-3-9761-3033 Fax 61-3-9761-3044

■ Ebara Great Pumps Co., Ltd.

North Industrial Zone, Phase II, Ruian, Zhejiang 325204, P.R.China
Phone 86-577-6532-2287 Fax 86-577-6532-3555

■ Ebara Machinery (China) Co., Ltd.

Room No.303, Beijing Fortune Plaza, No.7, Dongsanhuan Zhonglu Road, Chaoyang District,
Beijing, 100020 P.R.China
Phone 86-10-6530-9996 Fax 86-10-6530-8968

■ Ebara Machinery Zibo Co., Ltd.

No.7 Kaifaqu North Road, New and High Technology Zone, Zibo City, Shandong Province
255086, P.R.China

Phone 86-533-3919555 Fax 86-533-3919567

■ P.T.Ebara Indonesia

Jl.Raya Jakarta-Bogor KM.32, Desa Curug, Cimanggis-Depok, Jawa Barat, 16953 Indonesia
Phone 62-21-8740852 Fax 62-21-8740033

■ Ebara Pumps Malaysia Sdn. Bhd.

6 Jalan TP3, UEP Subang Jaya Industrial Park, 47620 Subang Jaya, Selangor, Malaysia
Phone 60-3-8023-6622 Fax 60-3-8023-9355

■ Ebara Pumps Philippines, Inc.

Canlubang Industrial Estate, Cabuyao 4025, Laguna, Philippines
Phone 63-49-549-1806 Fax 63-49-549-1915

■ Ebara Fluid Machinery Korea Co., Ltd.

3rd Fl. Hyun-Seok Tower, 50, Seolleung-Ro 93-Gil, Gangnam-Gu, Seoul, 135-513 Korea
Phone 82-70-4362-1100 Fax 82-70-8230-2030

■ Ebara Engineering Singapore Pte. Ltd.

No.1 Tuas Link 2, Singapore 638550
Phone 65-6862-3536 Fax 65-6861-0589

■ Ebara (Thailand) Limited

3 Fl., ACME Bldg., 125 Petchburi Road, Thungphayathai, Rajthevee, Bangkok, 10400, Thailand
Phone 66-2216-4935 Fax 66-2216-4937

■ Ebara Vietnam Pump Company Limited

Nguyen Trai Road, Hai Duong City, Hai Duong Province, Vietnam
Phone 84-320-3850-182 Fax 84-320-3850-180